

T.17S.,R.9W.,W.M.

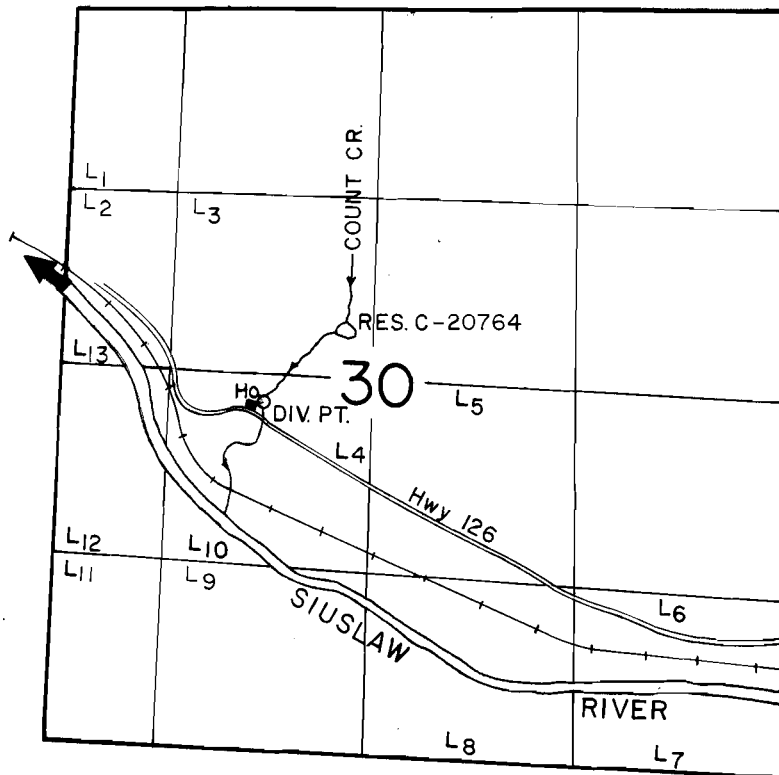

DIV. PT. LOC.: 200'S. & 760'W. FROM THE CENTER OF SEC. 30

SCALE: 1" = 1320'

FINAL PROOF SURVEY
UNDER

Application No. 61433... Permit No. 45822.....
IN NAME OF

GEORGE J. & JUANITA BROOKS

Surveyed Sept. 25, 1985, by T. WARREN.....