

T.2S., R.44E., W.M.

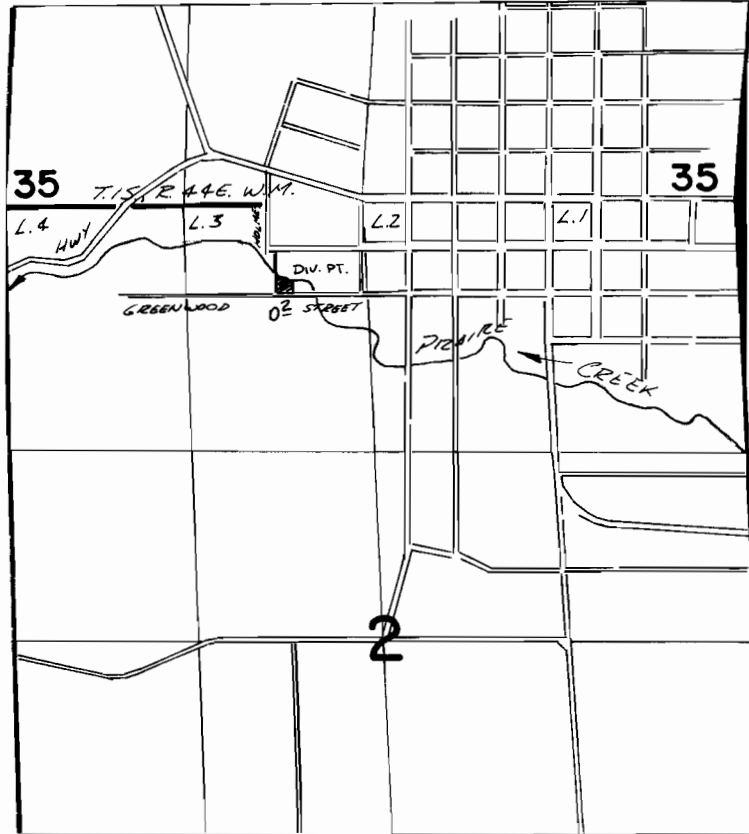

Div. Pt. Loc: 500' S. & .930' E. FROM NW COR. SEC 2

**FINAL PROOF SURVEY**  
UNDER

Application No. **57923** Permit No. **43656**...  
IN NAME OF

**ESTATE OF T. ESMOND JEWELL**.....

Surveyed *Aug. 9*..... 19*82*, by *V. B. Church*.....