

P# 38579

T.4S. R.12E. W.M.

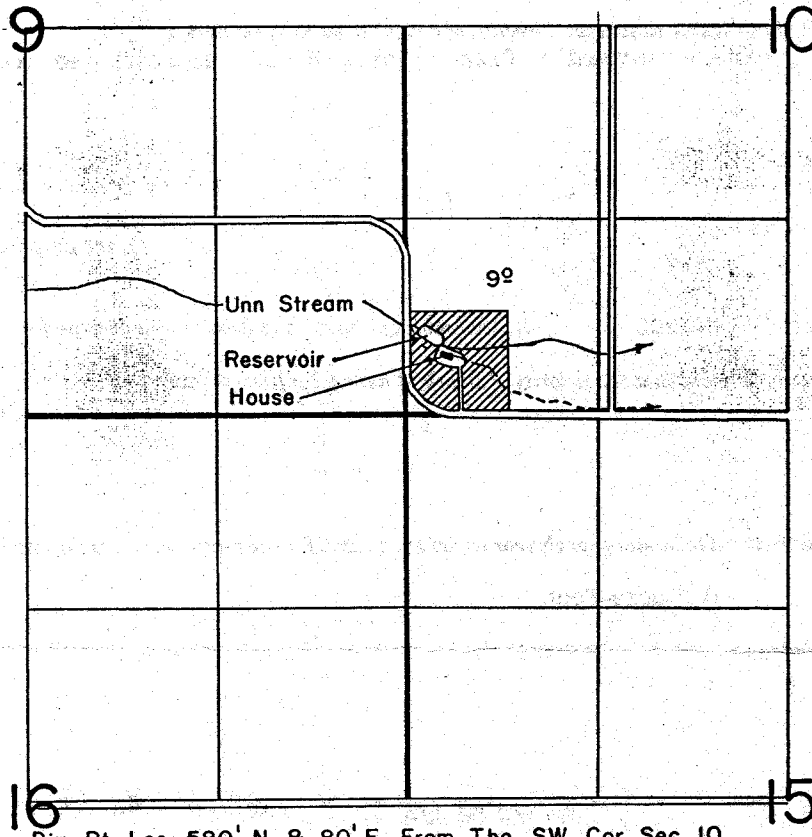

Div. Pt. Loc. 580' N. & 80' E. From The SW Cor. Sec. 10

480 250

FINAL PROOF SURVEY

UNDER

R-53089 R-6202
 Application No.53090 Permit No.38579
 IN NAME OF

CARL R. & BEVERLY J. ZAPFFE

Surveyed June 30 1982, by T. Paul.....