

P# G-7596

T.2N.R.14E.W.M.

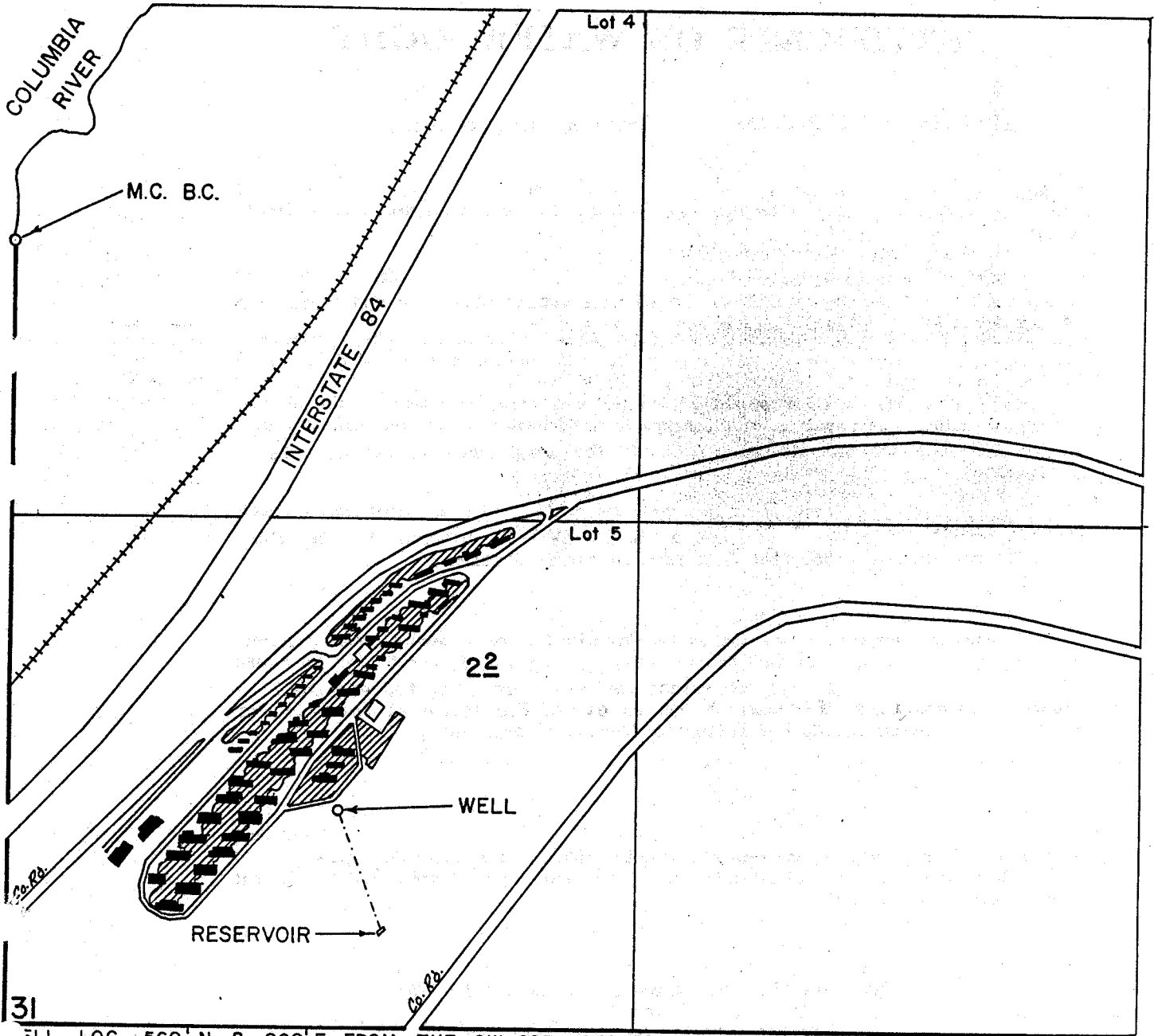

ELL LOC. 560' N. & 860' E FROM THE SW COR. SEC. 31

SCALE: 1" = 400'

FINAL PROOF SURVEY UNDER

Application No. G-8449 Permit No. G-7596
IN NAME OF

CECIL & DOROTHY BYERS

Surveyed Jan. 18, 1982, by T. PAUL