

T. 5S., R. 1W. & 1E., W.M.

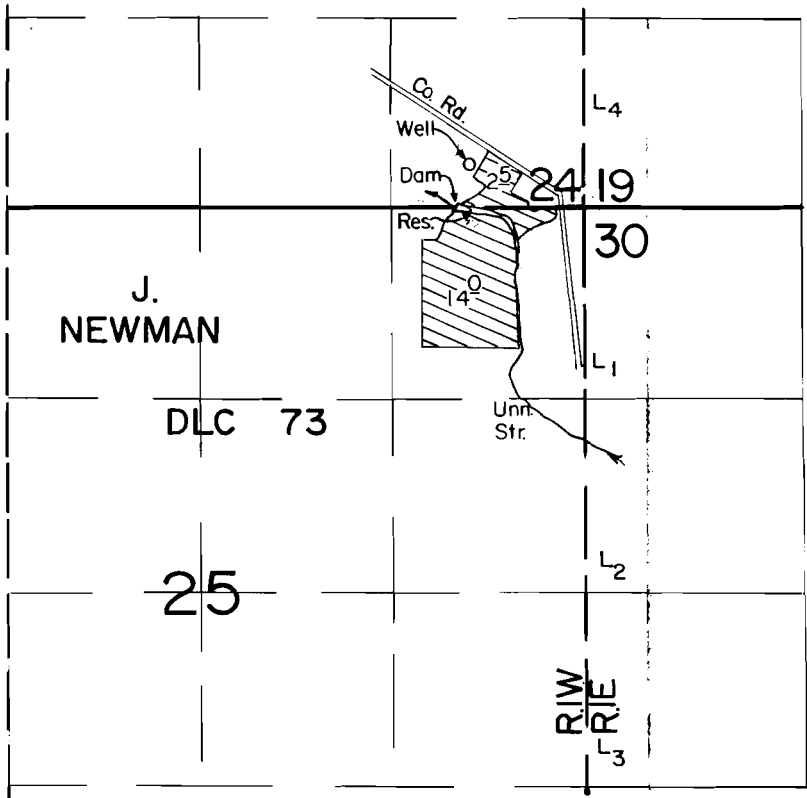

Dam Loc. : 900' W.
 Well Loc. : 300' N. & 780' W. ; both from NE Cor. Sec. 25.

Scale: 1" = 1320'

FINAL PROOF SURVEY UNDER

R-57445 R-7741
 57446 43711
 Application No. G-8820.. Permit No. G-8359.....
 IN NAME OF

FOTEI SHADRIN

Surveyed JULY 15... 1985., by J. Warren.....