

T.3S., R.1W., W.M.

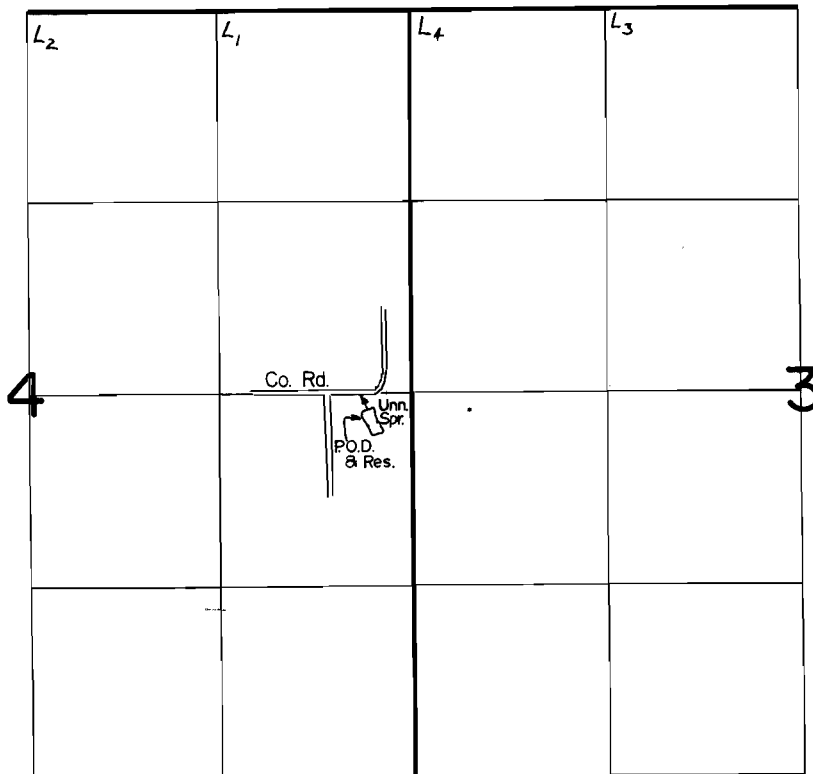

Spring & P.O.D. Loc. : 210' S. & 260' W. from E. 1/4 Cor. Sec. 4.

Scale: 1" = 1320'

FINAL PROOF SURVEY UNDER

R-62549 R-8468
Application No. 62550... Permit No. 46868.....

IN NAME OF

MARILYN DORSETT

Surveyed AUG. 20. 1985., by T. Warren.....