

G. 2314

T. 26 S. R. 15 E. W. M.

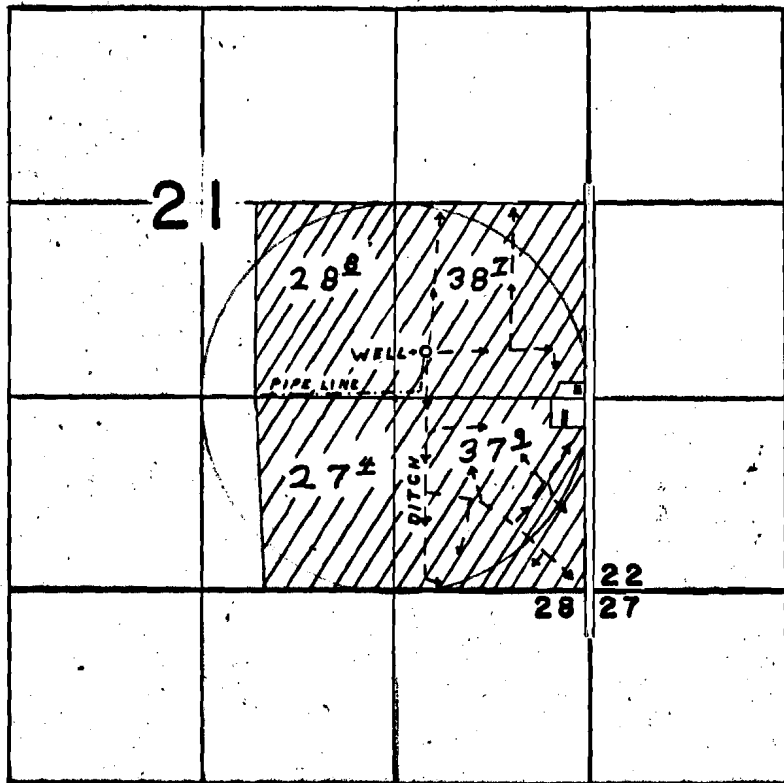

Well located 1620' N & 1110' W from SE cor. sec 21.

FINAL PROOF SURVEY
UNDER

Application No. G-2504. Permit No. G-2314.
IN NAME OF

JACK L. KITTREDGE

Surveyed AUG. 6. 1968, by L. E. GOULD.

P:G 2314
See next page
35751
55397
T5411
T9033

T. 26 S., R. 15 E., W.M.

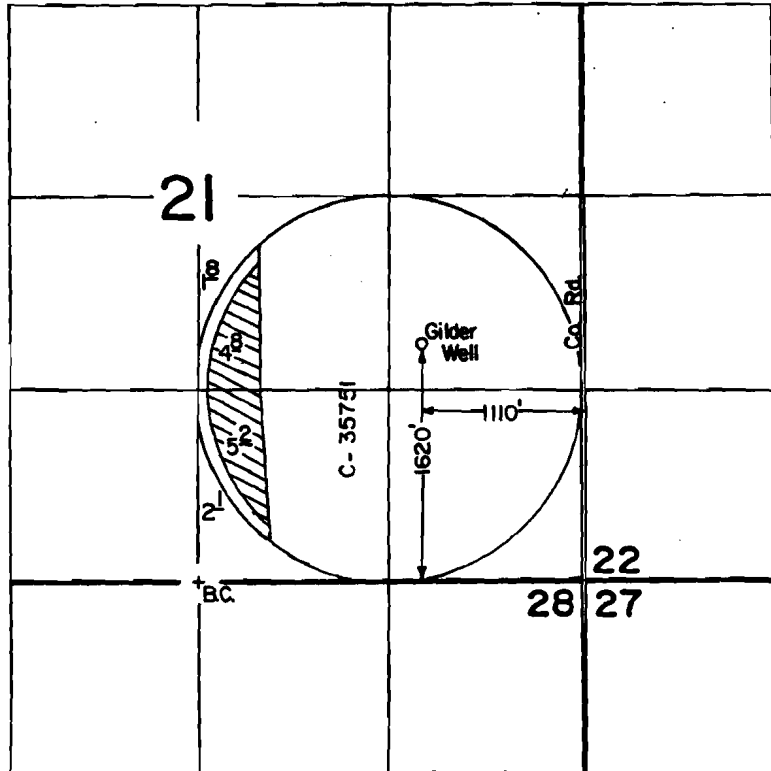
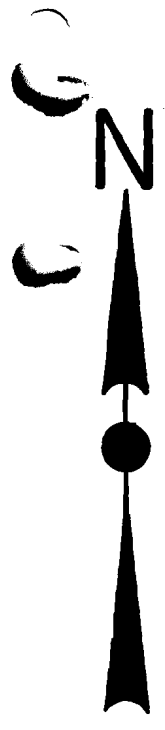

Scale: 1" = 1320'

FINAL PROOF SURVEY UNDER

Transfer 5411

Application No. Permit No.

IN NAME OF

JACK & DORIS KITTREDGE

Surveyed Sept. 18... 1985., by ...T.M. Warren....