

T. 4 S., R. 1 W., W.M.

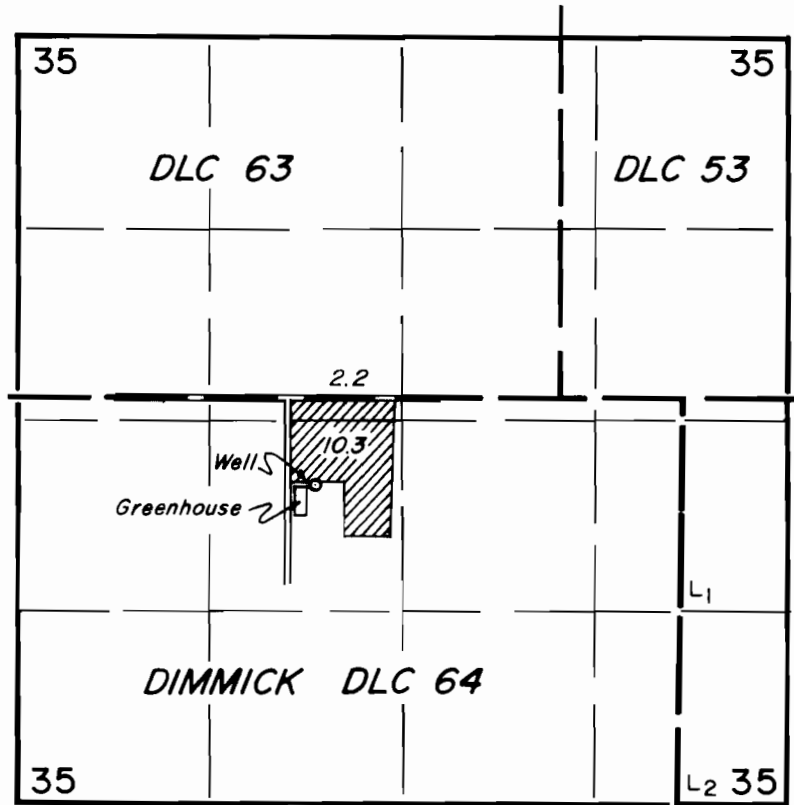

Well Loc.: 440' S. & 590' W. from the center of section 35

FINAL PROOF SURVEY UNDER

Application No. G. 6187. Permit No. G. 6078.....
IN NAME OF

Donald J. & Mary Angela Dieringer

Surveyed AUG. 29, 1979, by *d. B. B...*