

T. 6S., R. 3W., W.M.

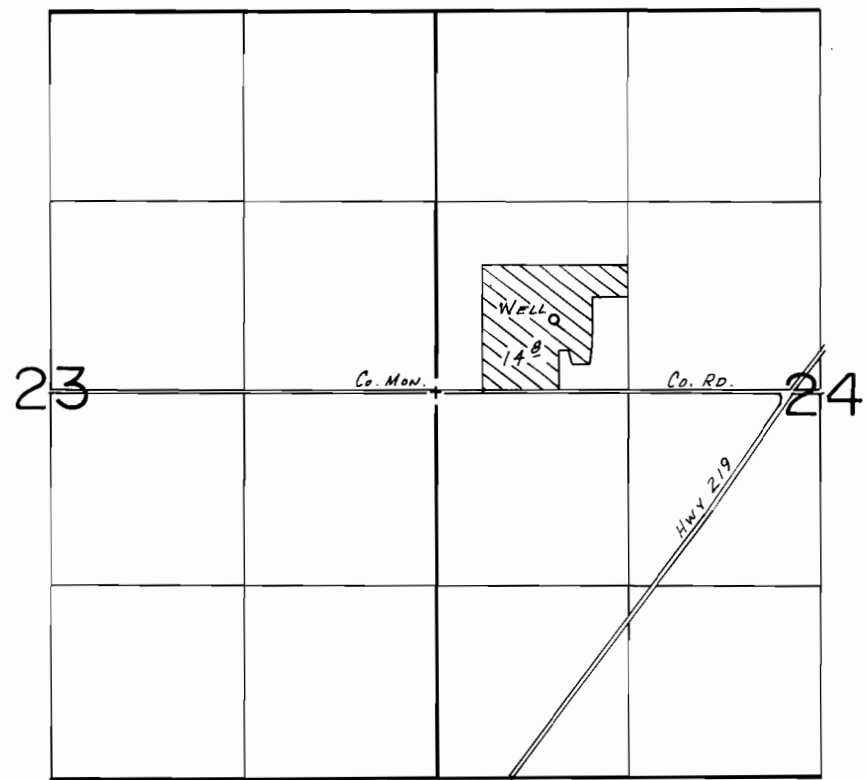

WELL LOC.: 500' N. & 810' E. FROM W 1/4 COR. SEC. 24.

SCALE: 1" = 1320'

FINAL PROOF SURVEY
UNDER

Application No. G-10995 Permit No. G-10115....
IN NAME OF

.....ESTATE OF ALLEN LEE.....

Surveyed Mar. 31..... 1986., by T.M. WARREN....

4/16/86
BWB