

T. 38 S., R. 2 W., W.M.

SEC. 29

SE 1/4 SW 1/4

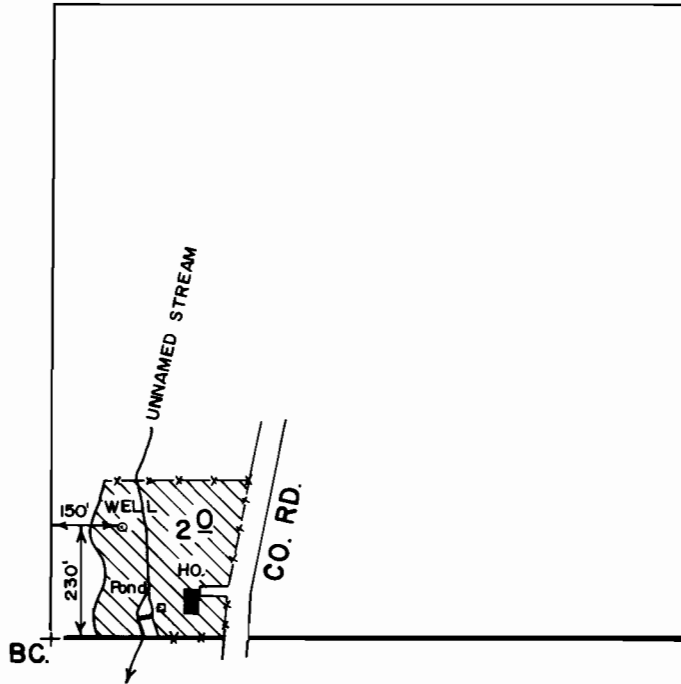

**FINAL PROOF SURVEY**

UNDER

Application No. G-7545 Permit No. G-7015.....  
IN NAME OF

.....**MALCOLM BROWN**.....

Surveyed May 5, 1982, by B.R. SUND.....

SCALE: 1" = 400'