

LAND
SURVEYS
EXAMINATIONS
REPORTS

IRRIGATION
SURVEYS
EXAMINATIONS
REPORTS

S. A. MUSHEN
CIVIL ENGINEER

LAKEVIEW, OREGON.

Application No. 7685
Permit No. 4911

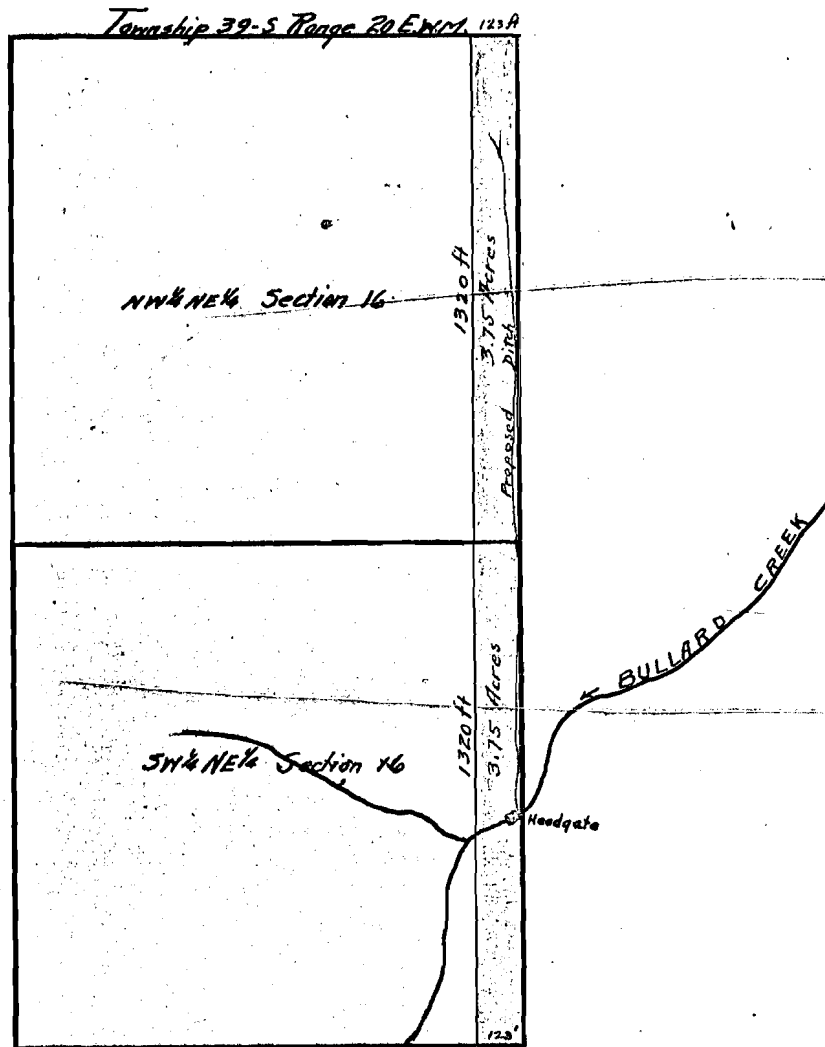

Map to accompany Water Application
F. J. struck

Scale 500' = one Inch
December 28, 1920

This map made by me from notes furnished by applicant
S. A. Mushen C.E.