

T.5S. R.2W. W.M.

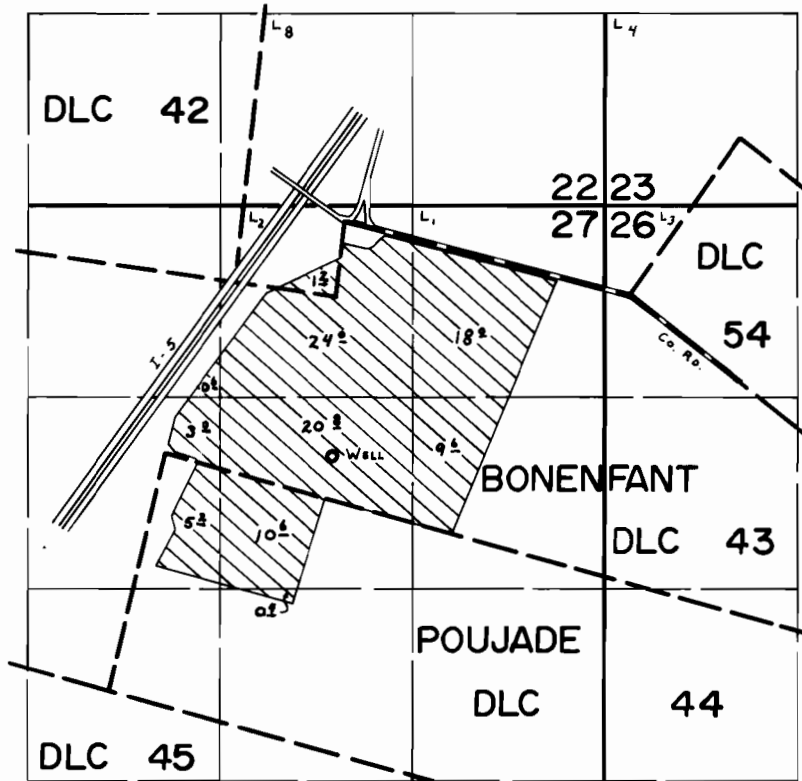

Well Loc: 20'S. & 1150'E. fr. N.W. Cor. POUJADE DLC. 44.

**FINAL PROOF SURVEY**  
UNDER

Application No. G-8758. Permit No. G-8169....  
IN NAME OF

.....EDWARD DRESCHER.....

Surveyed July 8, 1980, by C. L. Hughes.....