

T.26S., R.34E., W.M.

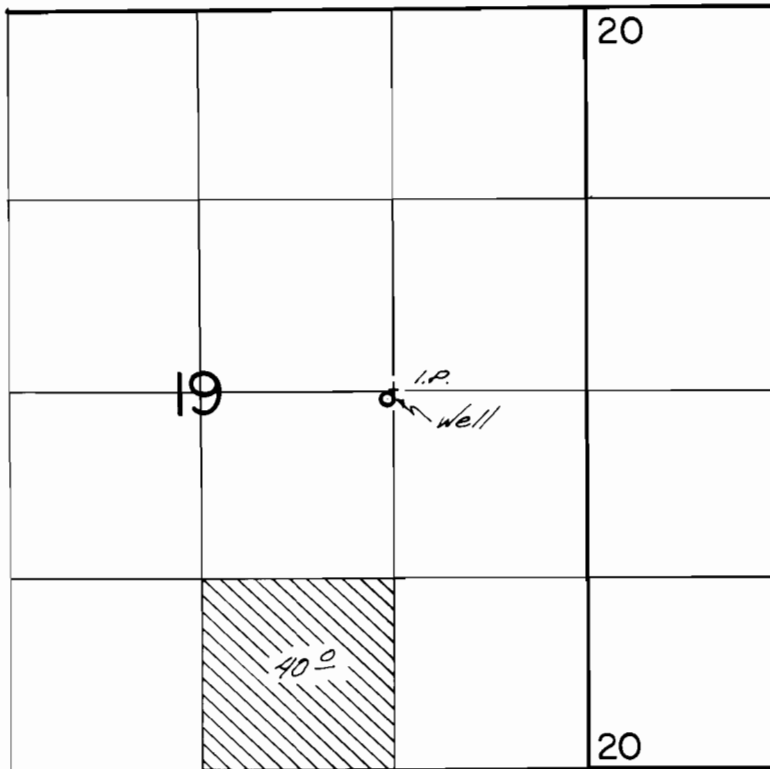

Well Loc.: 70' S. & 40' W. from NE corner NW $\frac{1}{4}$ SE $\frac{1}{4}$

FINAL PROOF SURVEY
UNDER

Application No. G-880 Permit No. G-8242
IN NAME OF

Nevin Thompson

Surveyed AUG 26, 1979, by R.G. MUCKEN

PTS-1979-H1