

T. 6N., R. 35E., W.M.

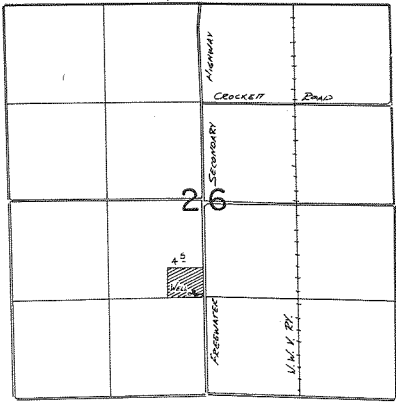

Well loc: 1390'N. & 210'W. FROM 5/4 COR. SEC 26

**FINAL PROOF SURVEY**  
UNDER

Application No. G:8115... Permit No. G:7495  
IN NAME OF

..... DAN L. LEFORE .....

Surveyed April... B... 1982.. by *Ch. L. ...*