

T. 6N., R. 35E., W.M.

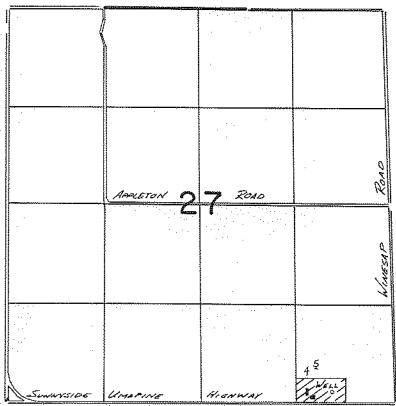

WELL LOCATED 150' N. & 860' W. FROM SE COR. SEC 27.

FINAL PROOF SURVEY
UNDER

Application No. G:8851. Permit No. G:8300
IN NAME OF

CLAYTON L. & NORMA J. HEINE

Surveyed Aug. 16, 1982, by V.L. GURCH