

17 701

T. 13. R. 3E. W.M.

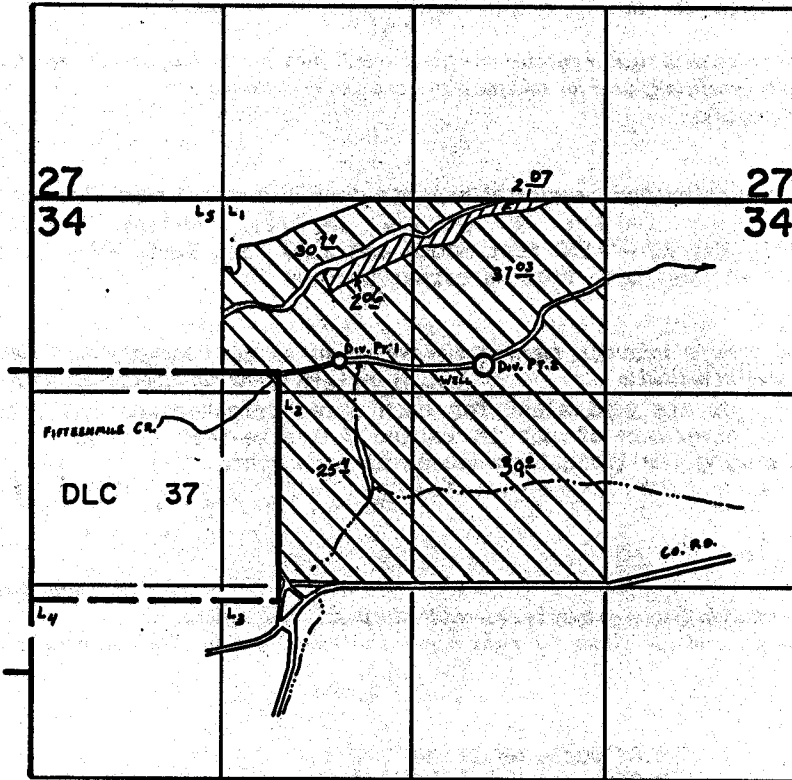

WELL Loc: 1150' S. & 3120' E.
 Div. Pts. Loc: #1- 1130' S. & 2150' E. } ALL FROM N.W. COR SEC. 34.
 #2- 1100' S. & 3120' E.
 ▨ - PRIMARY IRR. (APP. 56677) SUR IRR. (APP. 0-8461)
 ▩ - SUPP. IRR. (APP. 6-8461)

FINAL PROOF SURVEY UNDER

G-8461 G-8176
 Application No. 56647. Permit No. 43251.....
 IN NAME OF

.....KENNETH PURDOM.....

Surveyed June 26, 1979, by C. I. HUGHES.....