

T.1N., R.13E., W.M.

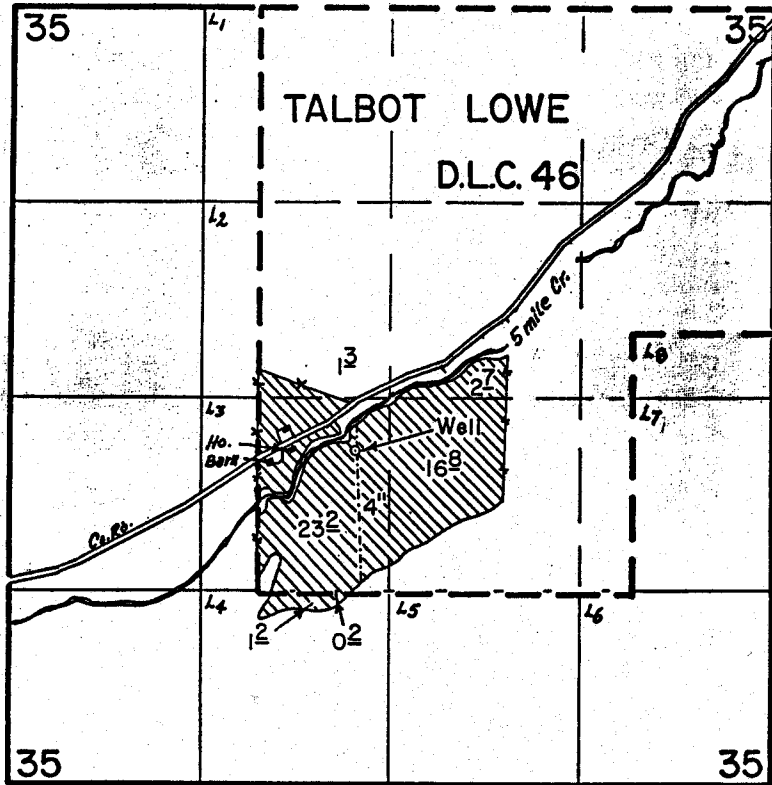

Well Loc. 350' S. & 2400' E. From The W 1/4 Cor. Sec. 35

**FINAL PROOF SURVEY**  
UNDER

Application No. G-7389. Permit No. G-6903.  
IN NAME OF

.....WILLIAM THOMAS.....

Surveyed Dec. 8, 1982, by T. J. Paul.....