

T. 5 & 6 S., R. 1 E., W. M.

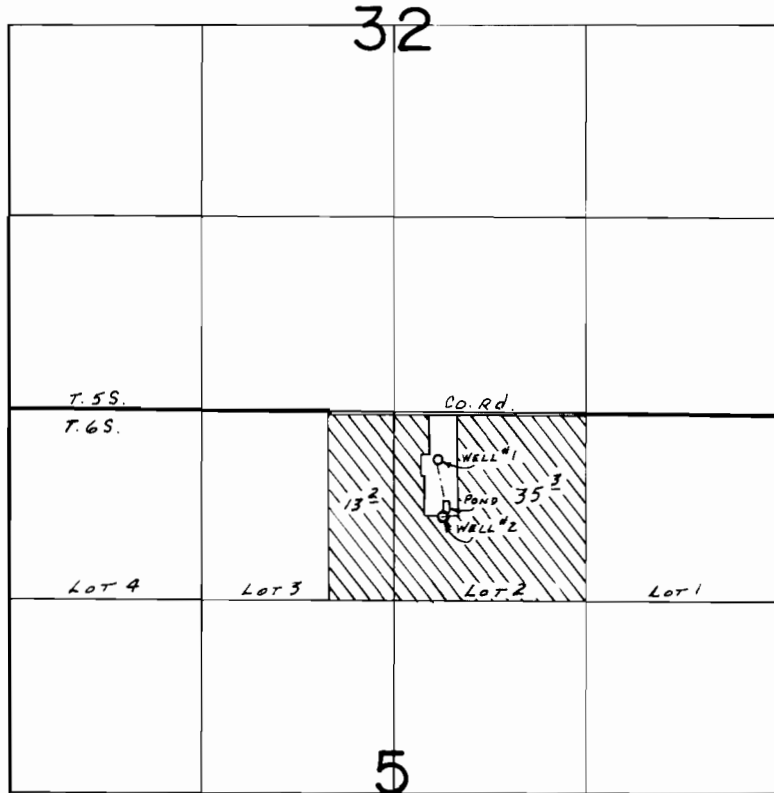

WELLS LOC: #1-300'S. § 2340' W., #2-710'S. § 2310' W., BOTH FROM THE NE COR. SEC. 5

SCALE: 1" = 1320'

FINAL PROOF SURVEY

UNDER

Application No. G-8383. Permit No. G-7782.....
IN NAME OF

.....VERL JACOBSON.....

Surveyed JULY 24, 1984., by B.W. BISHOP.....