

T.38S. R.4W. W.M.

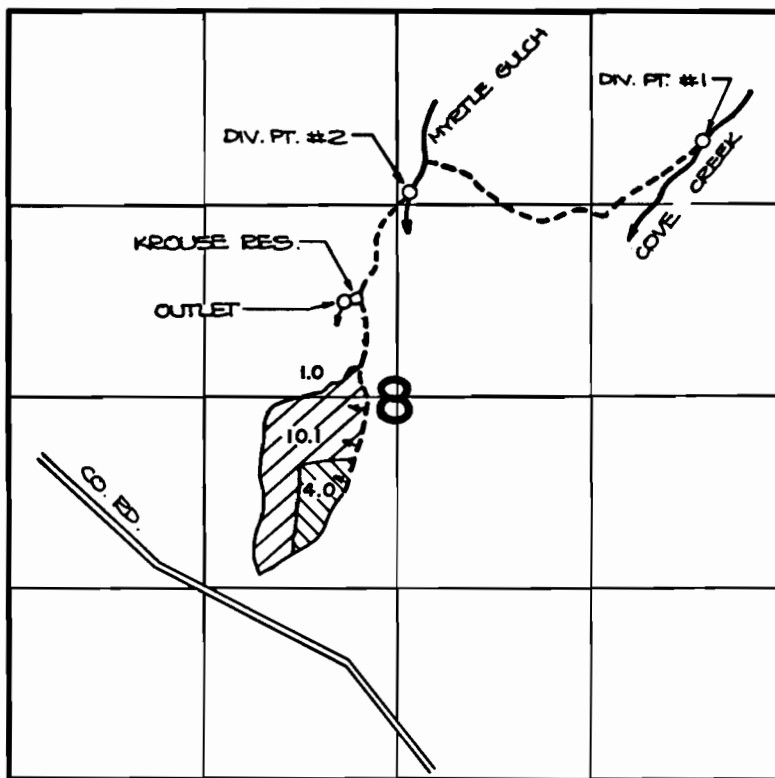

DIV. PT. #1 LOC: 1740' N. AND 560' W.; DIV. PT. #2 LOC: 1570' N. AND 2575' W.; BOTH FROM THE E. 1/4 CORNER OF SECTION 8.



PRIMARY



SUPPLEMENTAL

FINAL PROOF SURVEY

UNDER

46686

34984

Application No. R-46685 Permit No. R-5611.....

IN NAME OF

FRANCIS A. KROUSE

Surveyed APR. 22.. 1982., by B. SUND.....