

T.37S.,R.5W.,W.M.

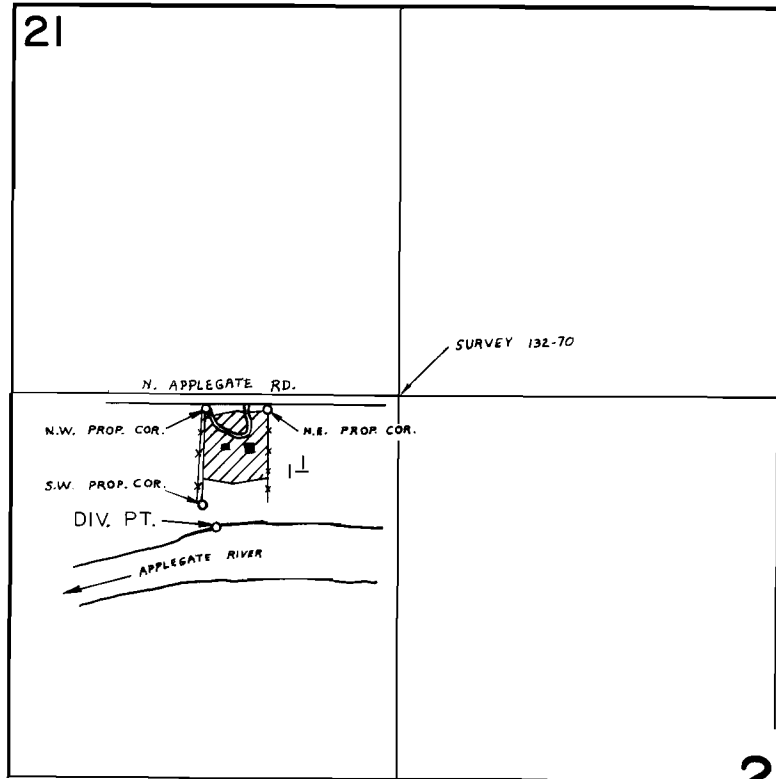

DIV. PT. LOC.: 460' S. & 625' W. FROM N.E. COR. OF S.W. 1/4 N.W. 1/4 SEC. 21.  
SCALE: 1" = 660'

**FINAL PROOF SURVEY**  
UNDER

Application No. 61854 Permit No. 46135  
IN NAME OF

JONATHAN D. & MARY LAZETTE AHLROTH

Surveyed OCT. 17, 1977, by B. SUND  
MARCH 29, 1982