

T. 9S., R. 2E., W.M.

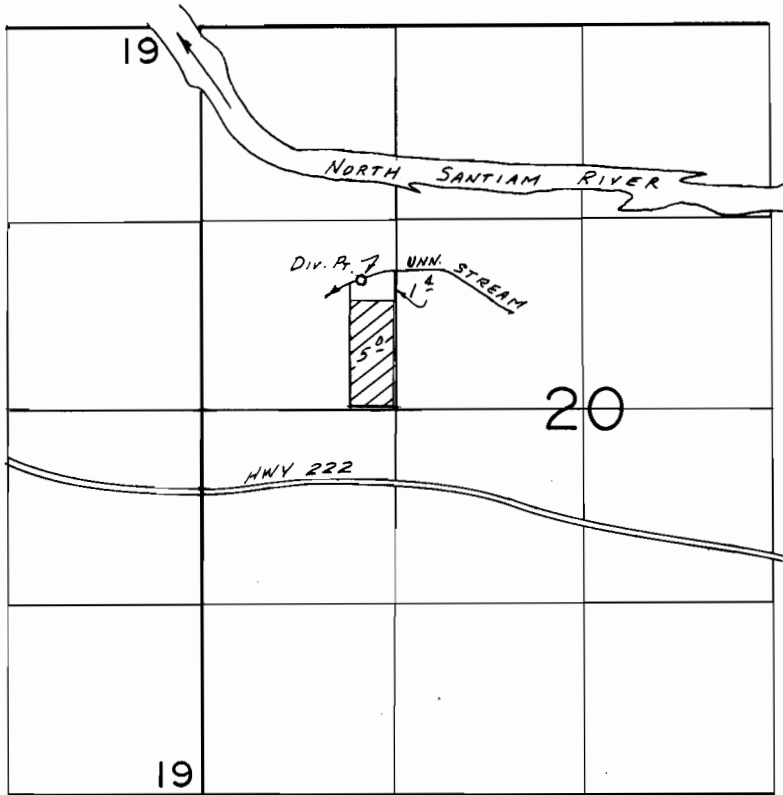

Div. Pt. Loc.: 900' N. & 1100' E. FROM N. 1/4 COR. SEC. 20

SCALE: 1" = 1320'

FINAL PROOF SURVEY
UNDER

Application No. 65177. Permit No. 47769.....
IN NAME OF

CHARLES L. JR. & ESTELLE A. CRUSON

Surveyed May 30... 1986, by B.W. BISHOP.....

11/15/86
BWB