

T. 7S., R. 2W., W.M.

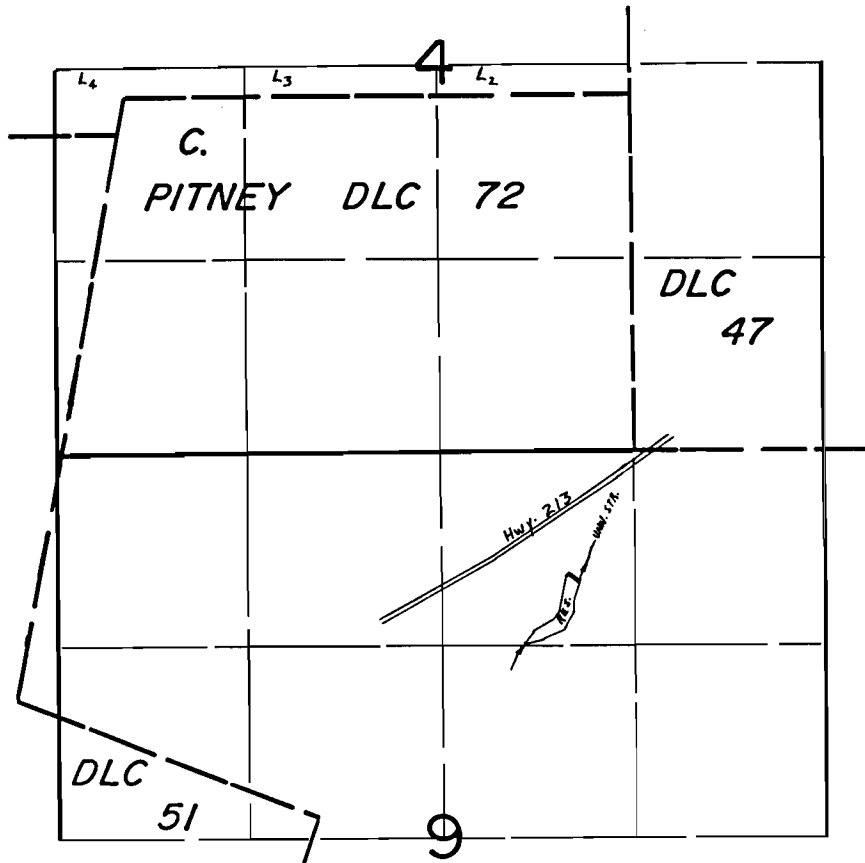

Dam Loc. : 850' S. & 1740' W. from NE Cor. Sec. 9.

Scale: 1" = 1320'

FINAL PROOF SURVEY
UNDER

R-68025

R-9690

Application No. 68026... Permit No. 48425.....

IN NAME OF

LORIS C. HARRELL

Surveyed April 15, 1986, by T. Warren.....