

T. 6 N. R. 35 E. W. M.

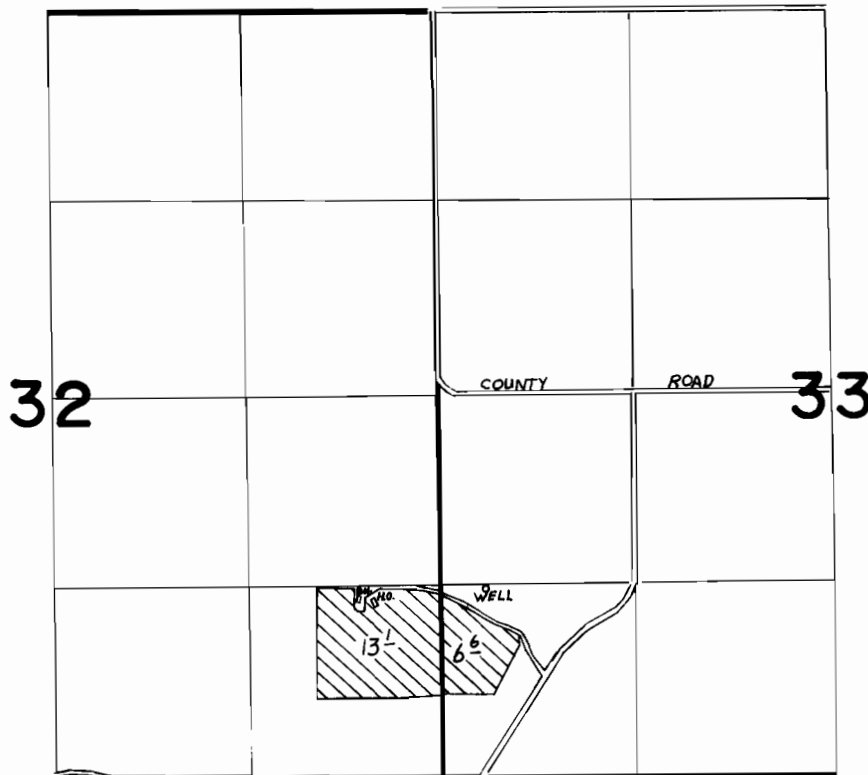

SCALE: 1" = 1320'



WELL LOCATED 1300' N. AND 320' E. FROM THE S.W. SEC. COR. SEC. 33

**FINAL PROOF SURVEY**  
UNDER

Application No. G-8990 Permit No. G-8413.....  
IN NAME OF

.....**JAMES M. BURNS**.....

Surveyed MARCH 13 1985, by V.L. CHURCH.....