

# T. 2N., R. 33E., W.M

## SE 1/4 SW 1/4 SECTION 31

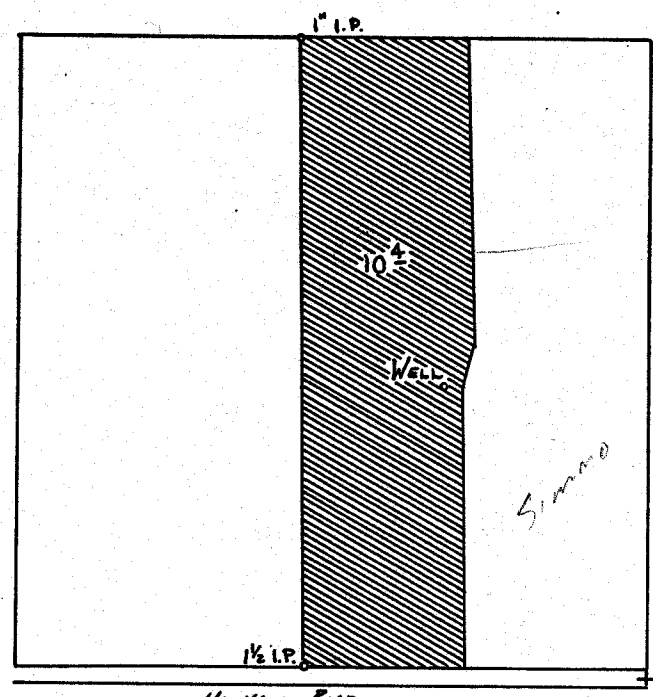

HANNA ROAD  
 WELL LOC: 600' N. + 430' W. FROM SW COR.  
 SEC 31

SCALE 1" = 400'

### FINAL PROOF SURVEY UNDER

Application No. G:10116 Permit No. G:9190  
 IN NAME OF

**ROBERT L. WAGNER**

Surveyed ~~May 26~~ 1983, by *V.L. Church*