

T.2N.,R.12E.,W.M.

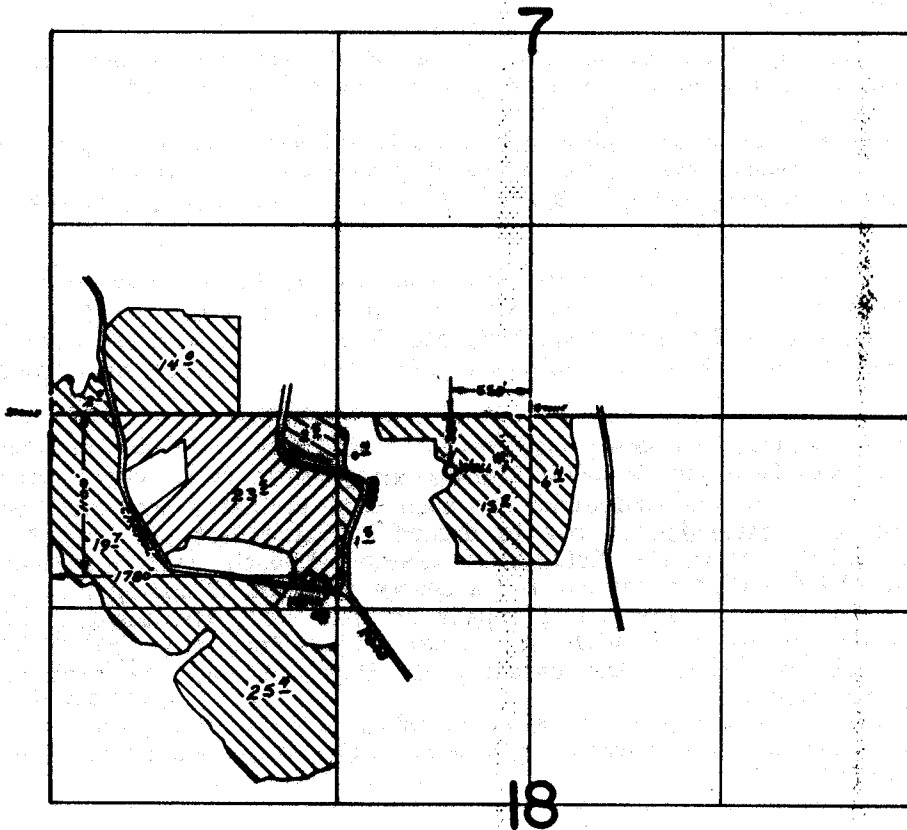

**FINAL PROOF SURVEY**  
UNDER

Application No. G-8296 G-7681  
G-10717.. Permit No. G-9795..  Well #1  Well #2  
IN NAME OF

**BRYCE W. MOLESWORTH**

Surveyed Sept. 30. 1982., by I. J. PAUL.....