

T. 27 S., R. 12 W., W.M.

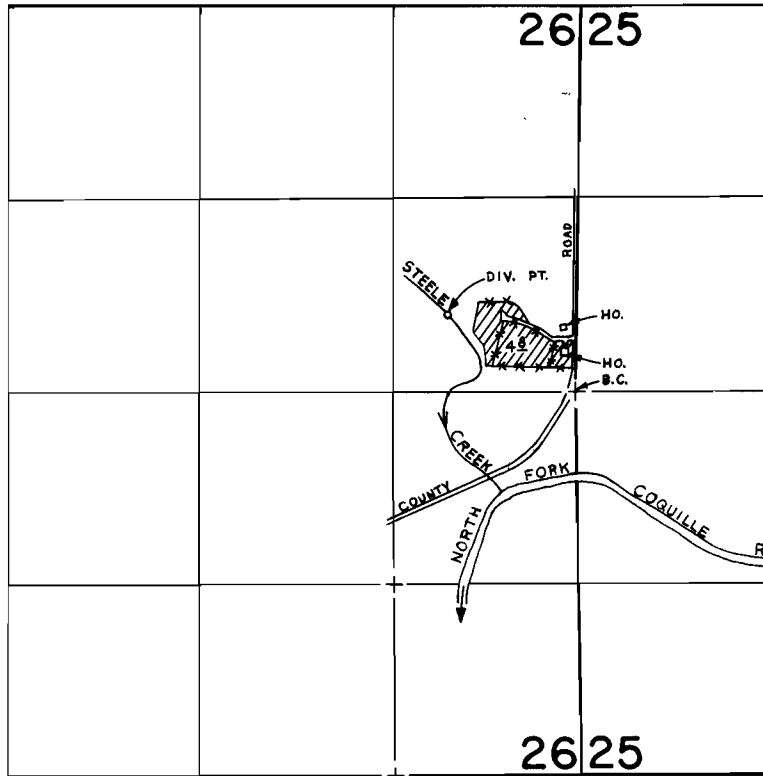

DIV. PT. LOCATED 530' N. & 870' W. FROM E. 1/4 CORNER SECTION 26

SCALE: 4" = 1 mile

FINAL PROOF SURVEY UNDER

Application No. 62162, Permit No. 46381.....
IN NAME OF

.....**CHESTER CRESS**.....

Surveyed AUG. 30, 1983, by P. THRELKELD