

3222
3655

Sec. 15 Sec. 10 Sec. 9 Sec. 10 Sec. 13

CAMP
ESTHER
APPELGATE
CAMP FIRE GIRLS
OF AMERICA

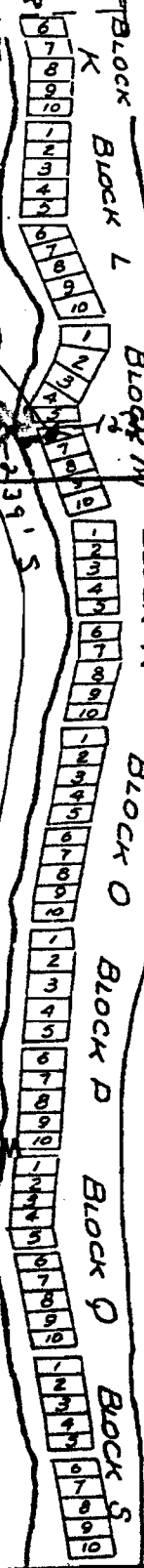

House
150

of Division

LAKE OF THE WOODS

1507
N-6

Sec. 15, T. 37 S., R. 5 E. W. 1/4
Application No. 58408
Permit No. 44223

WATER RESOURCES DEPT.
SALEM, OREGON

RECEIVED
JUN 18 1979

RECEIVED
MAR 16 1979
WATER RESOURCES DEPT.
SALEM, OREGON

Scale: 5 5/8" = 1 mile

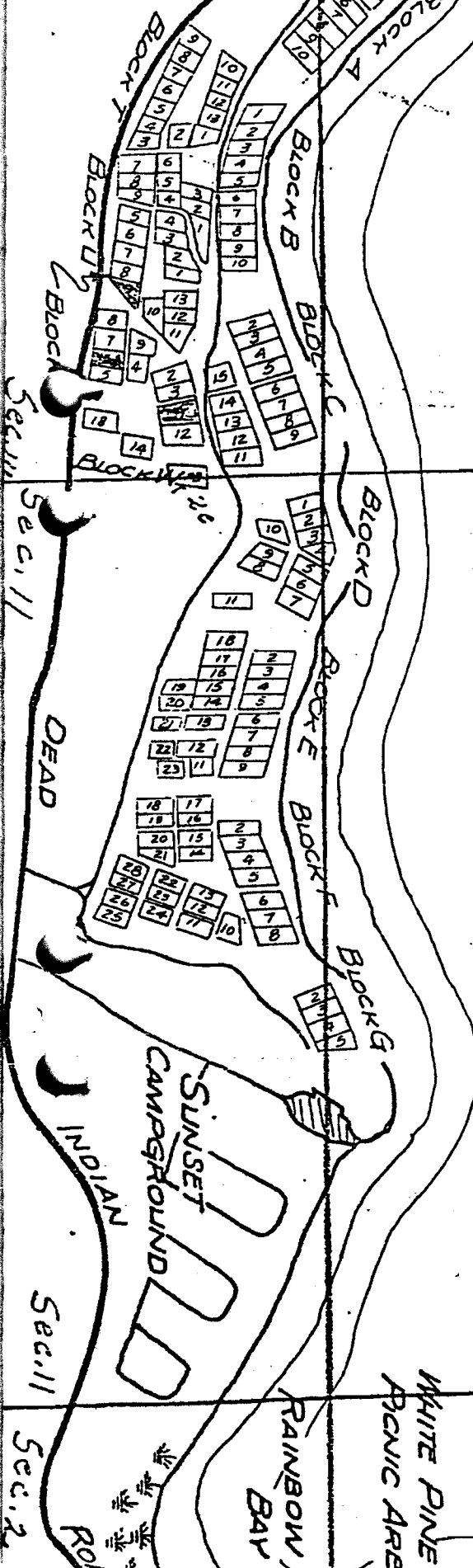

Sec. 11 Sec. 11 Sec. 12 Sec. 13