

44500
55182

RECEIVED

NOV - 1979

WATER RESOURCES DEPT
SALEM, OREGON

Application No. 58518
Permit No. 44508

RECEIVED
APR 10 1979
WATER RESOURCES DEPT.
SALEM, OREGON

Point of diversion
587'S. + 117'E. from NW COR. Sec. 14, T. 37S., R. 5E.,
SPECIAL USES

LAKE OF THE WOODS

Plat courtesy of Thyrre Dodge
Special Uses
Klamath Ranger Dist. LAKE OF THE WOODS
1936 California
Klamath Falls 97601

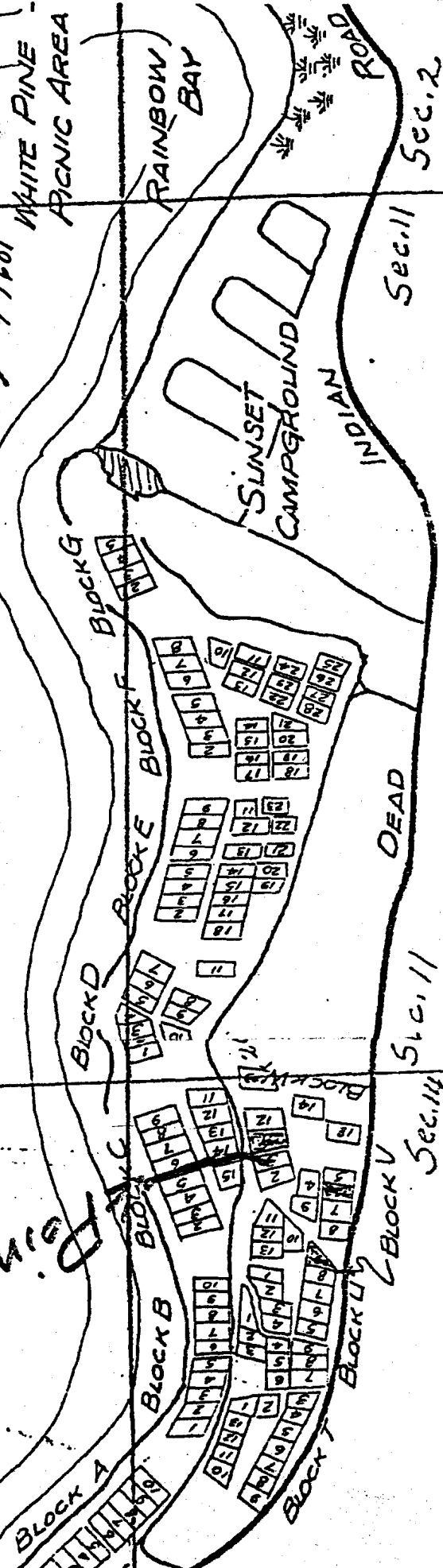

Sec. 10

Sec. 10

Sec. 10

Sec. 2

Sec. 11

Sec. 11

Sec. 11

Sec. 11

Block K
Block L
Block M
Block N
Block O
Block P
Block Q
Block R
Block S

CAMP OTHER
SPLEGATE
CAMP FIRE GIRLS
AMERICA

WISCONSIN STATE UNIVERSITY

Block A
Block B
Block C
Block D
Block E
Block F
Block G
Block H
Block I
Block J
Block K
Block L
Block M
Block N
Block O
Block P
Block Q
Block R
Block S

DEAD

INDIAN

SUNSET

CAMPGROUND

RAINBOW BAY

WHITE PINE PICNIC AREA