

T.5S. R.3W., W.M.

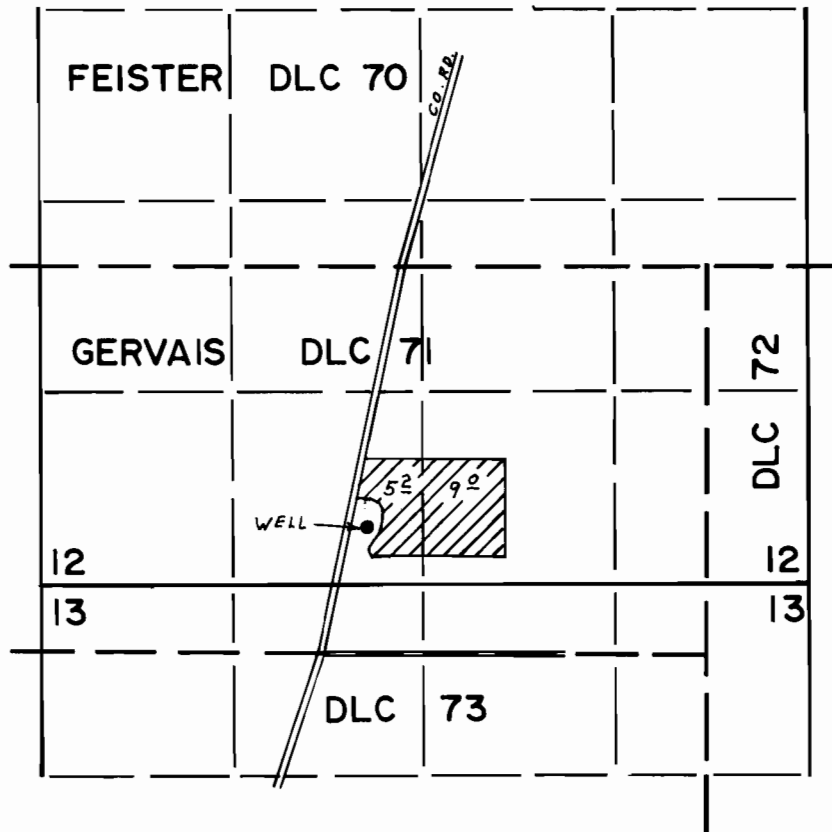

WELL LOC. 880' N. & 2320' W. FROM S.E. COR. GERVAIS DLC 71

FINAL PROOF SURVEY UNDER

Application No. G-8868. Permit No. G-8220.
IN NAME OF

JOHN & JANE STOCKFLETH

Surveyed APR. 24. 1979, by L. H. NUNN