

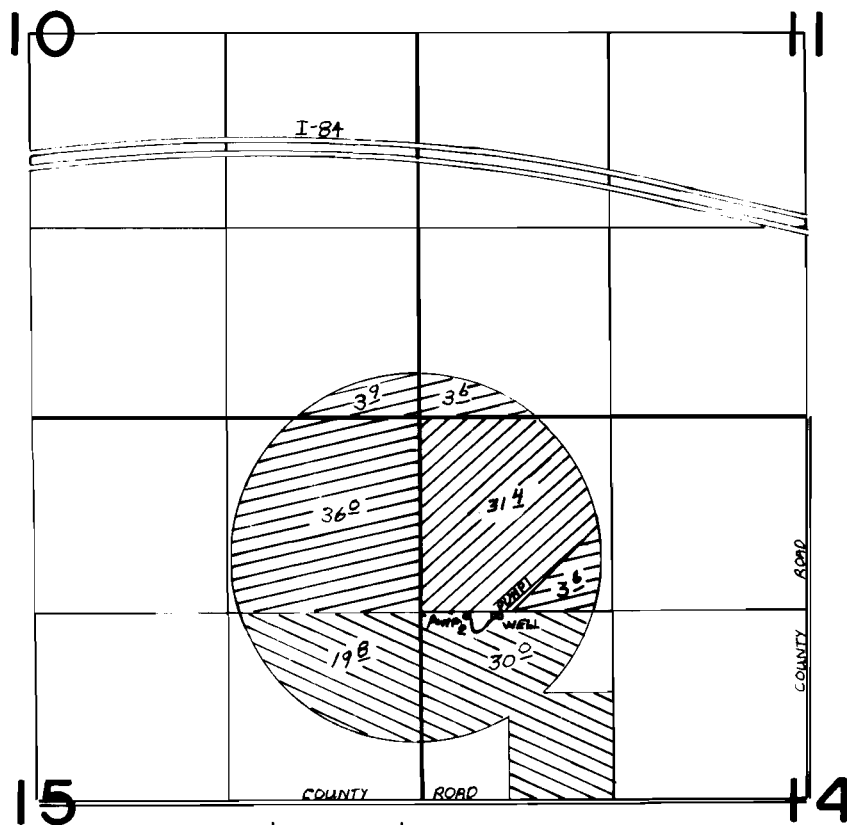

# T. 4 N., R. 25 E. W. M.

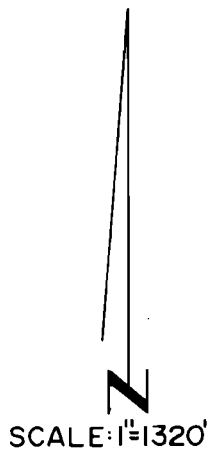

WELL LOCATED 1310' N. AND 2110' W. FROM CENTER 1/4 COR. SEC. 14  
 PUMP 1 LOCATED 1310' N. AND 2140' W. FROM CENTER COR. SEC. 14  
 PUMP 2 LOCATED 1310' N. AND 2350' W. FROM CENTER COR. SEC. 14

 PRIMARY PER. 46207  
 SUPPL. PER. G-9516

 PER. 46207 & G-9516  
 SUPPL.

 PER. G-9516 SUPPL.  
 PER. 46207 SUPPL.

## FINAL PROOF SURVEY UNDER

G-10034                      G-9516  
 Application No. 61029..... Permit No. 46207.....  
 IN NAME OF

**ROBERT G. SICARD & SONS**

Surveyed FEB. 19..... 1985., by V.L. CHURCH.....