

T. 27S., R. 12 W., W.M.

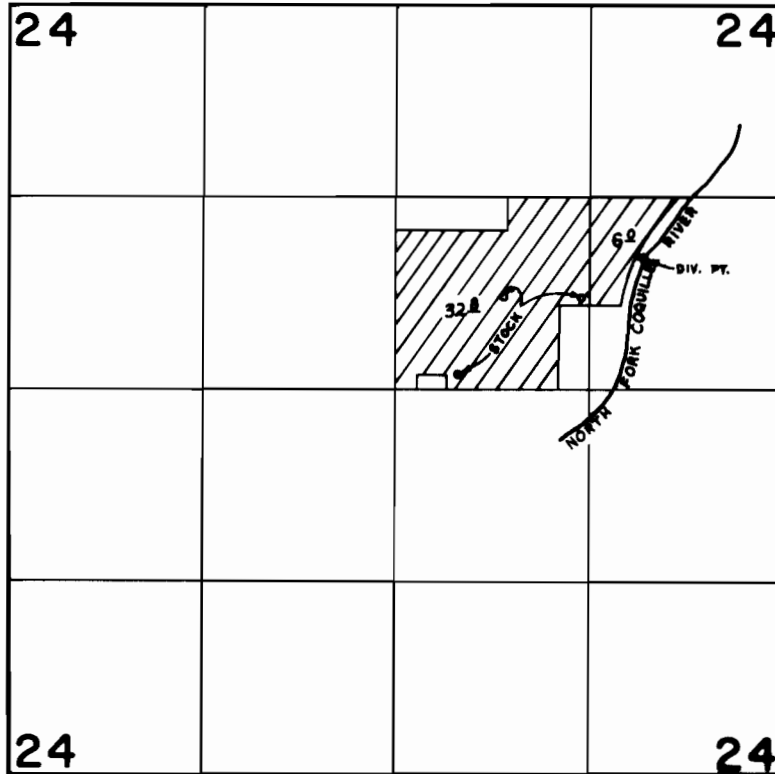

DIV. PT. LOCATED 300' N. & 1,680' E. FROM CENTER 1/4 CORNER SECTION 24

SCALE: 4" = 1 mile

FINAL PROOF SURVEY UNDER

Application No. 58207.. Permit No. 43853.....
IN NAME OF

GORDON D. & ELEANOR M. COOKE

Surveyed AUG. 31., 19.83, by S. DONALDSON