

# T.33S., R.2E., W.M.

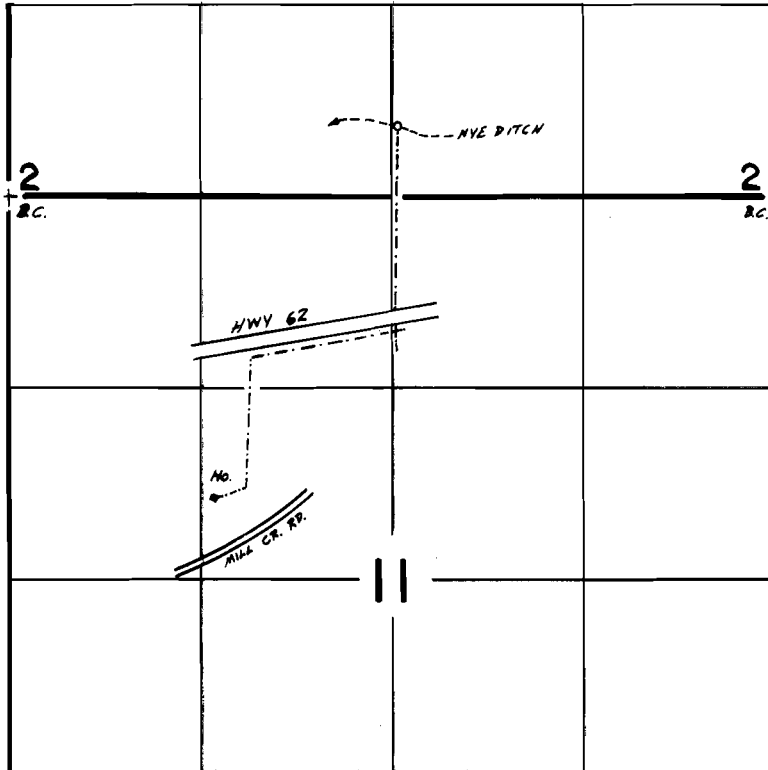

MILL CREEK DIV. PT. : 1860' N & 2690' E FROM SW COR. SEC. 28., T. 32S., R. 3E., W.M.

SCALE 1"=1320'

## FINAL PROOF SURVEY UNDER

Application No. 63762 Permit No. 47309  
IN NAME OF

JERRY & MARCIA STEWART

Surveyed Oct. 17, 1985, by B.S. JAMES