

44226  
56034

CAMP ESTHER  
APPLEGATE  
CAMP FIRE GIRLS  
AMERICA

Application No. 58549  
Permit No. 44226

# LAKE OF THE WOODS

POINT OF DIVERSION - 1836' N and 1607' E  
OF THE SW CORNER OF SEC. 10 T37S, R5E.  
POINT OF USE - LOT 7, BLDG O OF LAKE OF THE  
WOODS SUMMER HOME TRACT.

APR 19 1979  
WATER RESOURCES DEPT.  
SALEM, OREGON

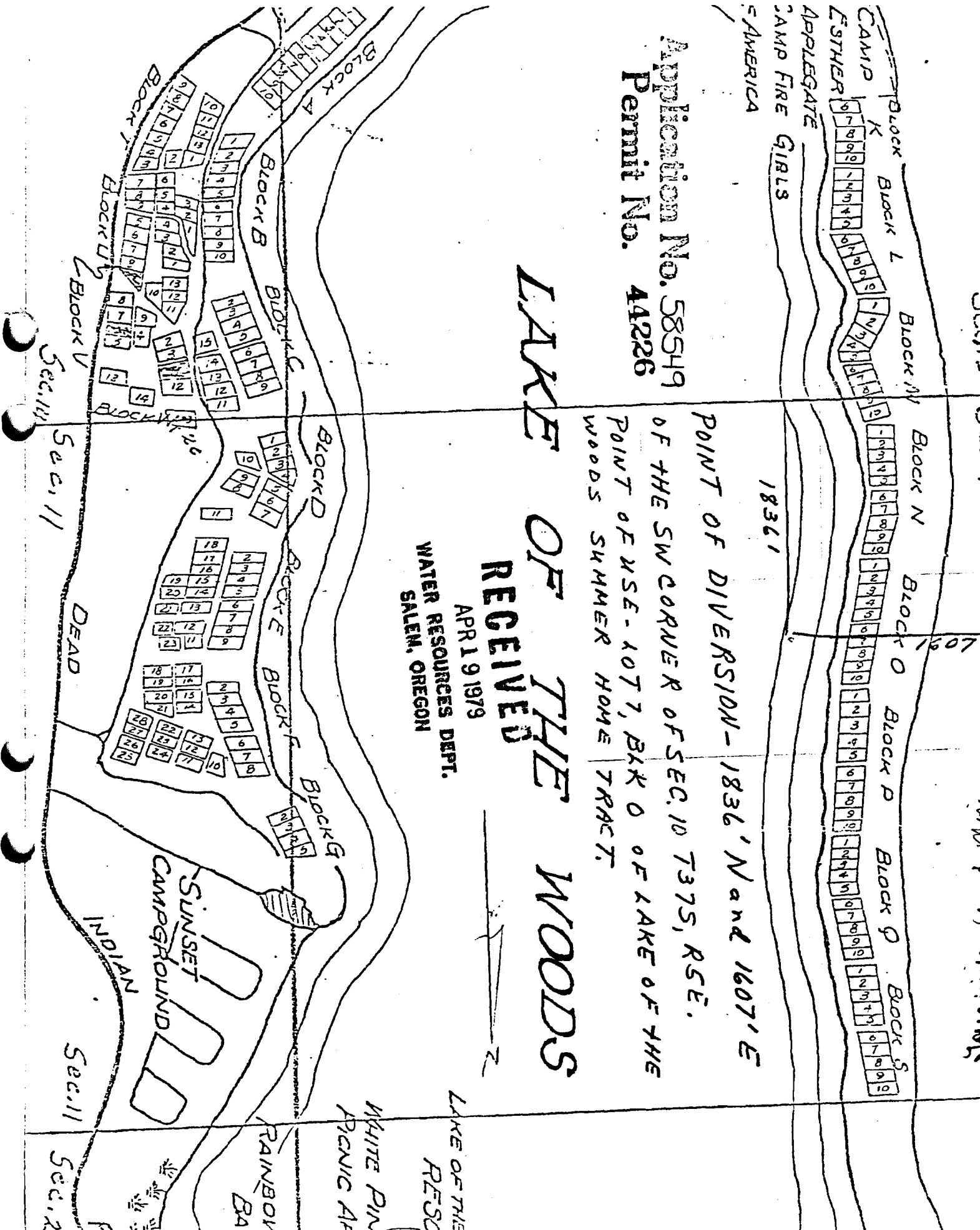

DEAD  
SUNSET CAMPGROUND  
INDIAN PICNIC AREA  
WHITE PINIC  
RAINBOW BAY

LAKE OF THE  
RESC

WHITE PINIC  
PICNIC AREA

RAINBOW  
BAY

SUNSET  
CAMPGROUND

INDIAN

Sec. 11

Sec. 12

1836'

1607'