

T. 7 & 8 S., R. 3 W., W.M.

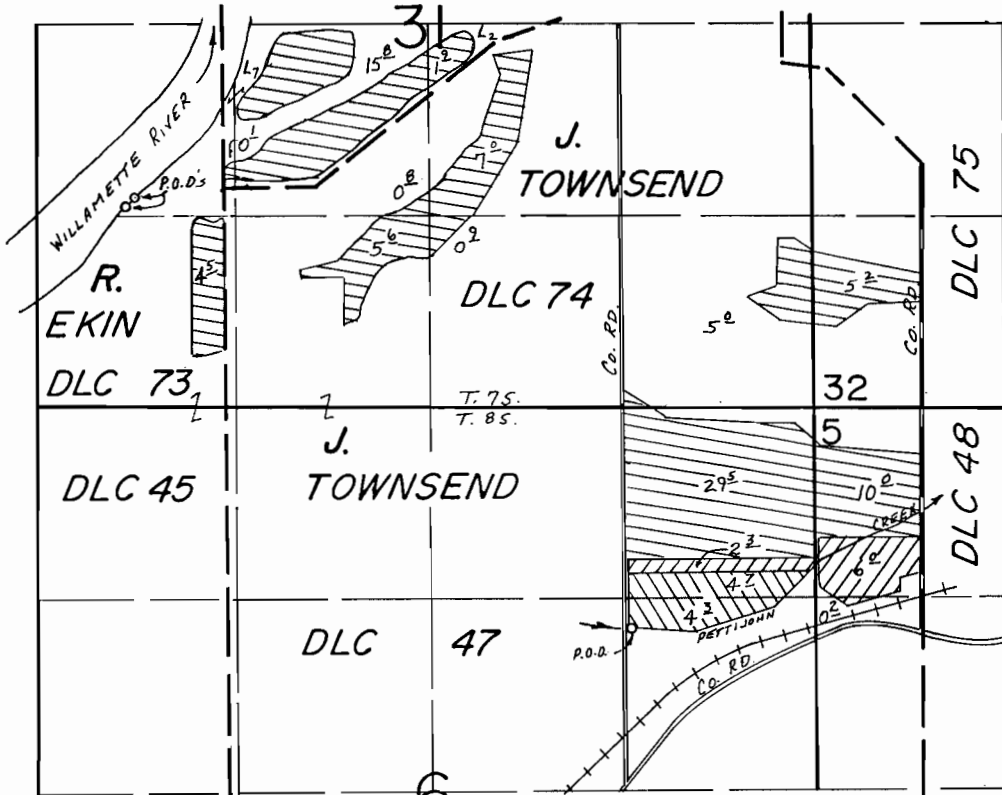

Willamette River P.O.D.'s: 1440' N. & 660' E., 1360' N. & 610' E., both from SW Cor. Sec. 31.  
 Pettijohn Crk. P.O.D. : 1510' S. & 1270' W. from NE Cor. Sec. 6.

Scale: 1" = 1320'

**FINAL PROOF SURVEY**

UNDER

63106

46657

63578

46853

Application No. 67982... Permit No. 48251.....

IN NAME OF

MILLER FORESTS

Surveyed May 15, 1985, by P.R. PAGTER.....

April 11, 1986, by T. Warren

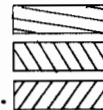

*To be cancelled*

11/5/86 TMW

41047-278-17L

*BWB*

(from appl. 72634)

67982

REMARKS: 86.3 ac. suppl to Permit # 46657

86.3 ac. x 1.5 AF/ac. = 129.45 AF.

19.8 ac. primary stored water only, 19.8 ac. x 2.0 AF/ac. = 39.6 AF.

Total Ac.Ft. = 169.05

We wish to authorize cancellation of Certificates 56059 and 56060  
water rights from Pettijohn Creek.

"I/we certify that the information I have provided in this application is an accurate  
representation of the proposed water use and is true and correct to the best of my  
knowledge."

NOTE: The permit, when issued, is for the beneficial use of water without waste. By law, the land use associated with this water use must be in compliance with statewide land-use goals and any local acknowledged land-use plan. It is possible the land use you propose may not be allowed if it is not in keeping with the goals and acknowledged plan. Your city or county planning agency can advise you about the land-use plan in your area.

x Walter R. Miller  
Signature of Applicant Walter R. Miller  
President, Miller Forests, Inc.

8/26/92  
Date

\_\_\_\_\_  
Signature of Co-Applicant, if any

\_\_\_\_\_  
Date