

56072 G-7145

67878
RECEIVED

T. 2N., R. 27E., W. M.

MAR 20 1987

WATER RESOURCES DEPT.
SALEM, OREGON

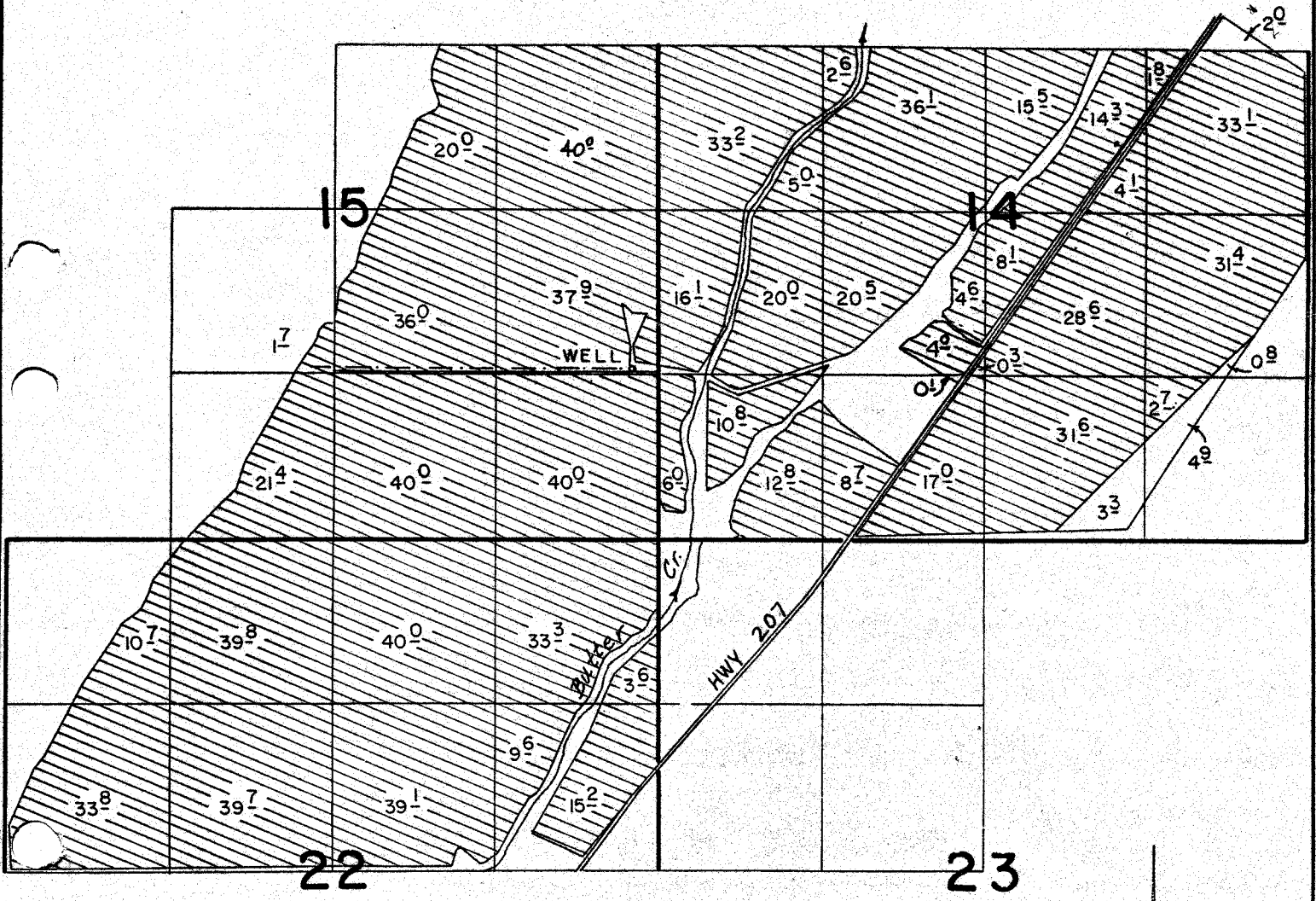

WELL LOCATED 1380' N. & 210' W. FROM SE COR. SEC. 15

FINAL PROOF SURVEY
UNDER

Application No. **G:7643** Permit No. **G:7145**...
IN NAME OF

J. & M. WATER WORKS

Surveyed **11-18**..... **1985**., by **V.L. CHURCH**.....

SCALE: 1" = 1320'

REV. 11-7-86 SC
REV. 10-23-86 VLC

61R, 62R

VLC.