

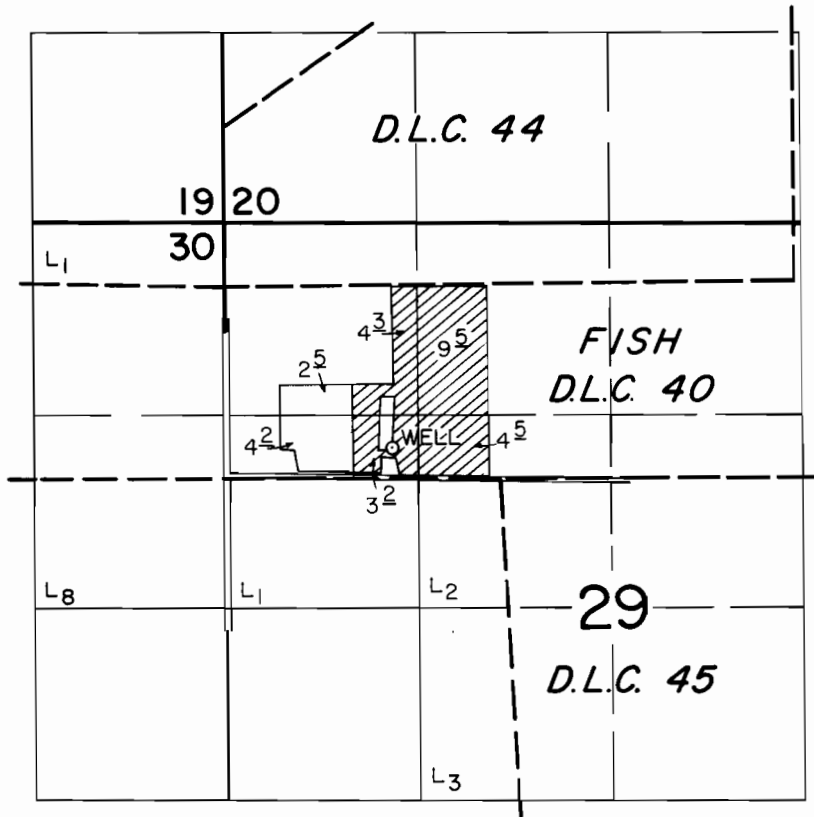

T. 4 S., R. 1 E., W.M.



WELL LOC: 1550' S. & 1150' E. FROM THE N.W. CORNER SEC. 29

SCALE: 1" = 1320'

FINAL PROOF SURVEY
UNDER

Application No. G-8395 Permit No. G-9486...
IN NAME OF

RONALD L. RUTZ

Surveyed JULY 3, 1985, by T. WARREN