

T. 2N., R. 34E., W. M.

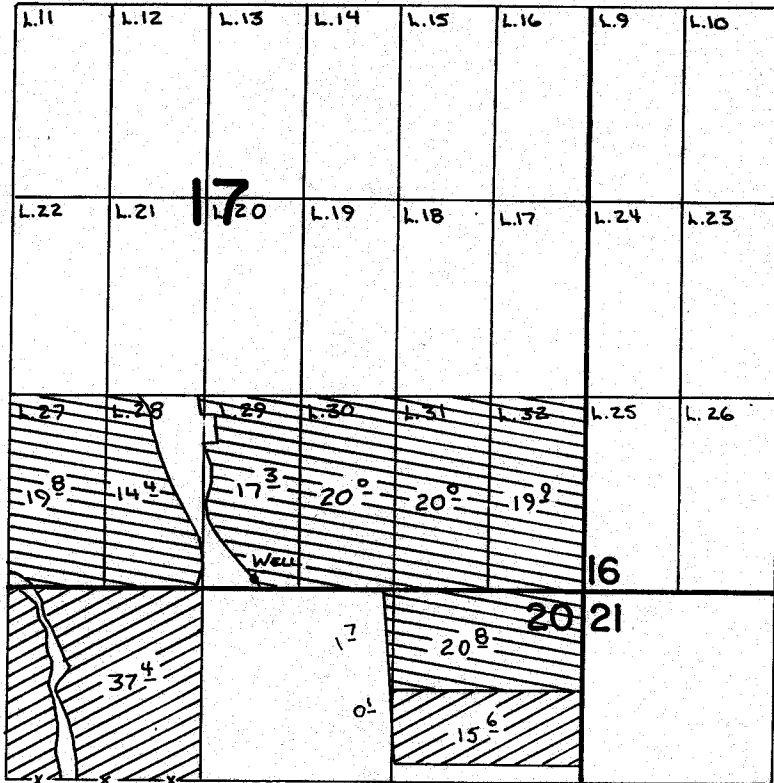

SCALE: 1" = 1320'

WELL LOCATED 70' N. & 350' E. FROM S¹/₄ COR. SECTION 17



SUPPLEMENTAL



PRIMARY

FINAL PROOF SURVEY UNDER

Application No. G:10616 Permit No. G:9752
IN NAME OF

RICHARD A. FOWLER

Surveyed 12-12 1984, by V.L. Church