

T.41S., R.13W., W.M.

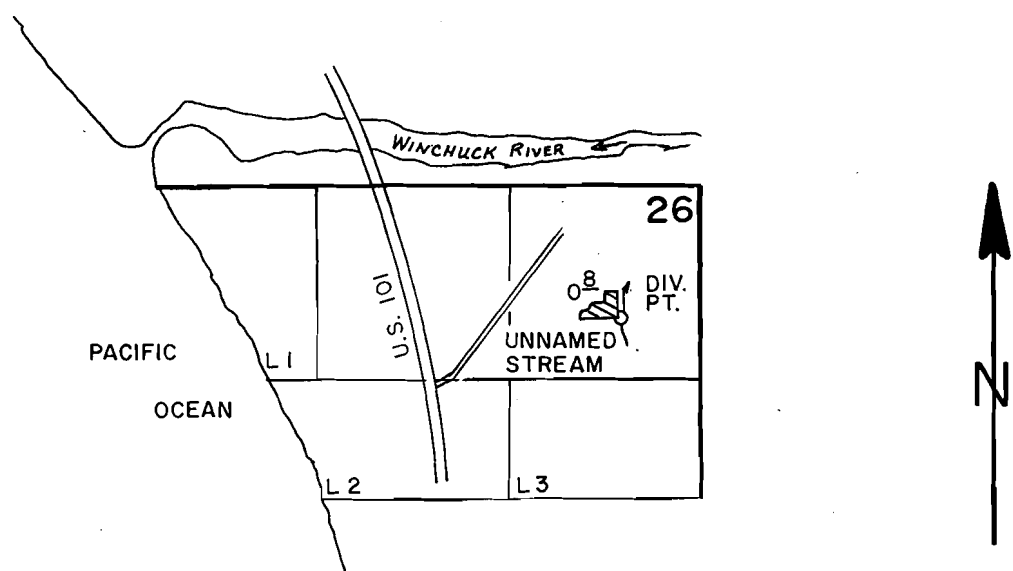

DIV. PT. LOC. 890' S. & 530' W. FROM THE NE COR. SEC. 26.

SCALE 1" = 1320'

FINAL PROOF SURVEY
UNDER

Application No. 63692 Permit No. 47128
IN NAME OF

FRED & PAULENE BAGLEY

Surveyed APRIL 8 1985, by L. E. CASHION