

T. 29 S., R. 6 W., W.M.

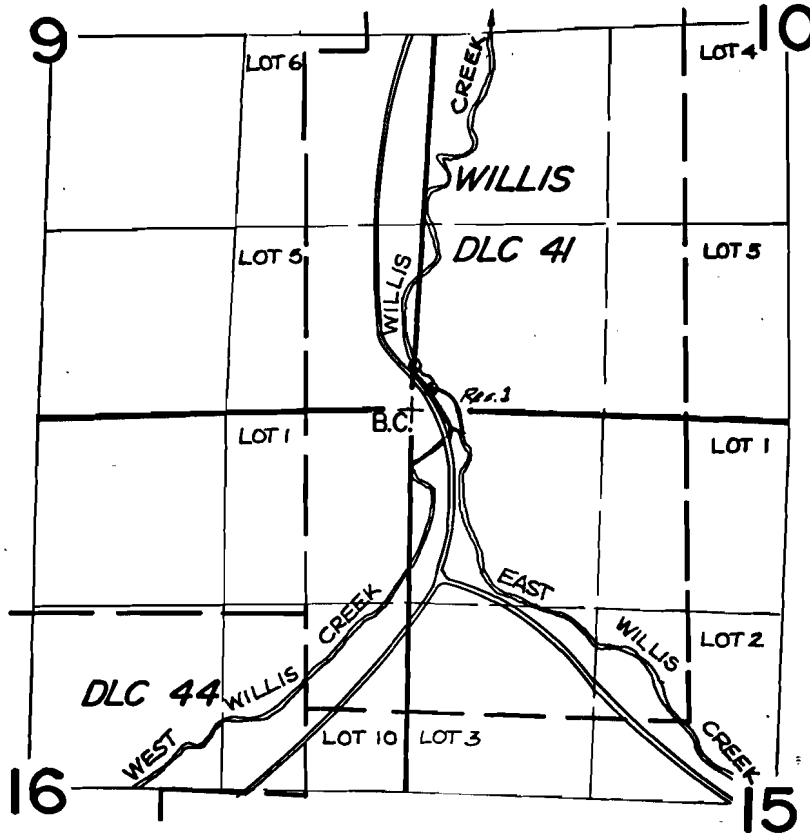

Res. 1 IS LOCATED 140' N. & 140' E. FROM THE SW CORNER SEC. 10

SCALE : 4" = 1 MILE

FINAL PROOF SURVEY
UNDER

R - 61874 R - 8329
Application No. .6303!... Permit No.46172.....
IN NAME OF

.....**DAVID WAYNE BIRTCH**.....

MAR. 25,
Surveyed .AUG. 18. 19.86., by .J.M.SCHMORDE...