

T.39S. R.3W. W.M.

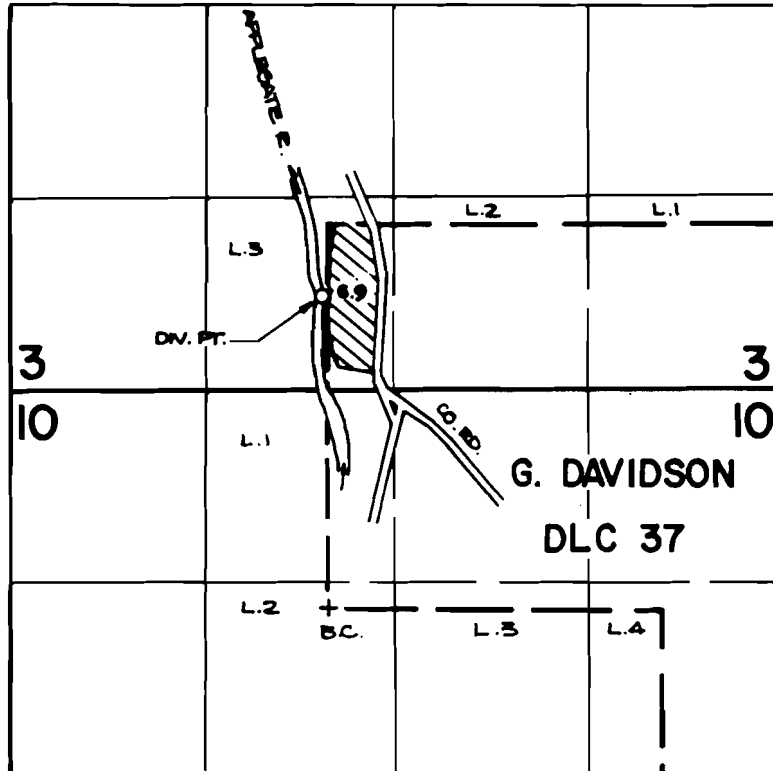

DIVERSION POINT IS LOCATED 650' N. AND 500' W. FROM THE S. 1/4 CORNER OF SECTION 3.

FINAL PROOF SURVEY

UNDER

61814

45883

Application No. 54504 Permit No. 40878

IN NAME OF

JIMMIE L. LONG

Surveyed MAY 18, 1982, by B. SUND