

T.39S., R.8W., W.M.

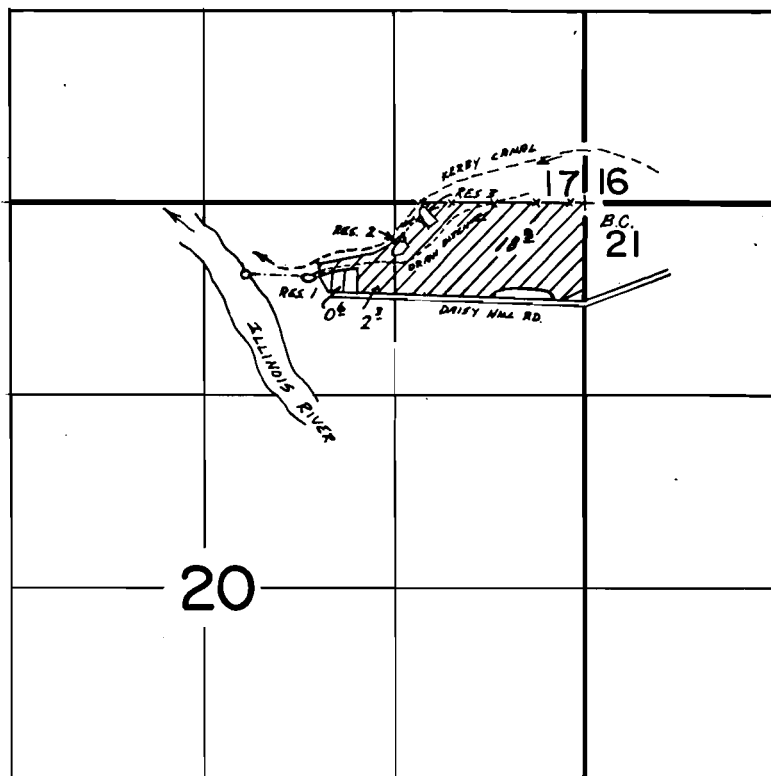

RESERVOIR 1: 500' S & 1900' W from NE Cor. SEC. 20.
 RESERVOIR 2: 300' S & 1300' W " " " " "
 RESERVOIR 3: 100' S & 1100' W " " " " "

Scale 1" = 1320'

 SUPPLEMENTAL

FINAL PROOF SURVEY UNDER

 PRIMARY

R-55659 R-6607

Application No. 54875.. Permit No. 41647.....

IN NAME OF

.....DAVID E. ATKIN.....

Surveyed Aug. 24, 1982, by B.R. SUND.....