

G-5878
56225
T8468

T.25S.R.15E.W.M.

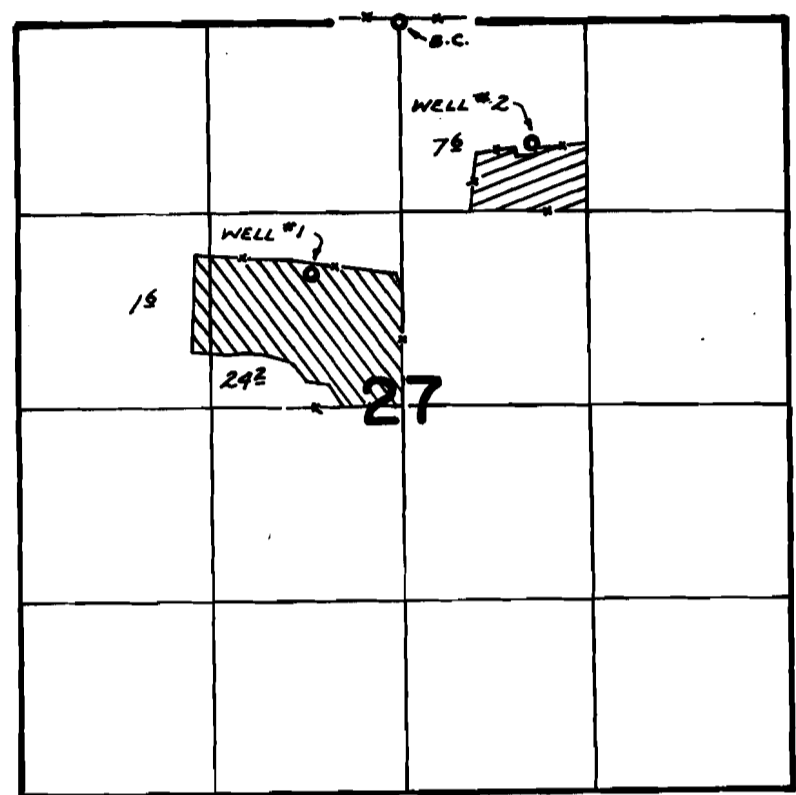

WELLS LOC: #1 - 1720'S. & 620'W ; #2 - 830'S. & 900'E. FROM N& COR. SEC. 27

FINAL PROOF SURVEY UNDER

Application No. G-6227 Permit No. G-5878
IN NAME OF

DVA

Surveyed AUG. 26, 1978, by S.P. APPLGATE