

# T.9S. R.1W., W.M.

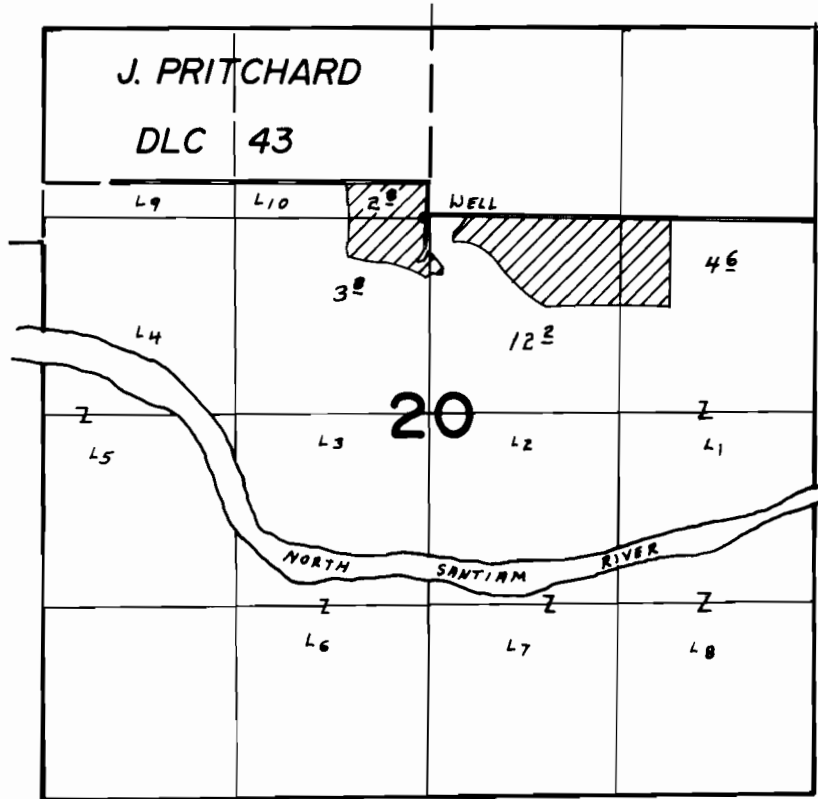

WELL LOC. 1320' S. & 2680' W. FROM N.E. COR. SEC. 20

## FINAL PROOF SURVEY UNDER

Application No. G-6028. Permit No. G-5715.....  
IN NAME OF

.....DORSEY B. GRAY.....

Surveyed APR. 29. 1979., by L.H. NUNN.....