

T.7S.,R.5&6W.,W.M.

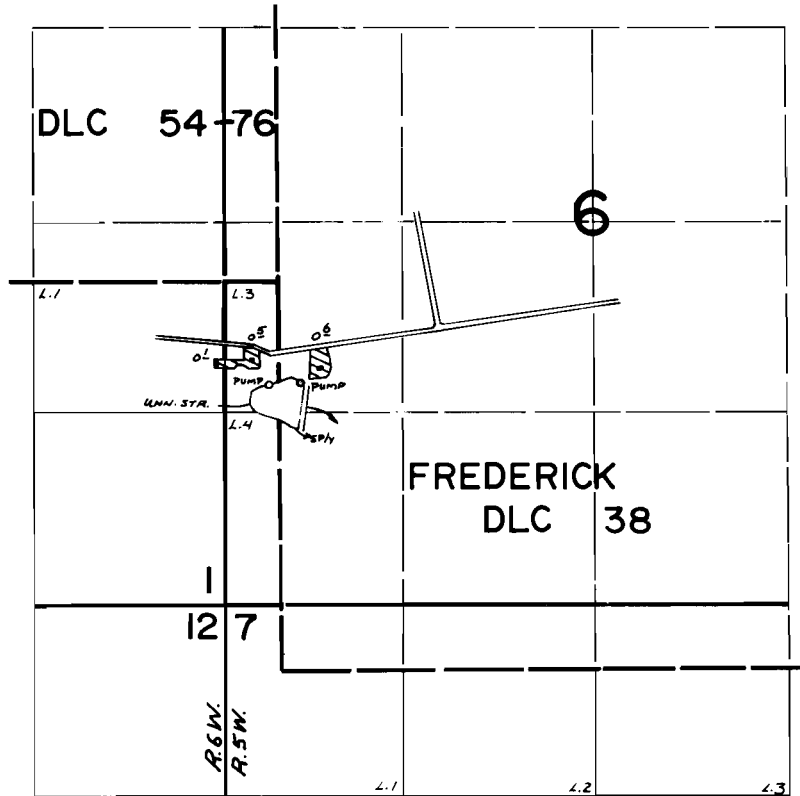

Dam Div. Loc.: 760' S., & 150' E. from SE Cor. Nicklin DLC 76.

FINAL PROOF SURVEY UNDER

Application No. ~~58282~~ ~~58283~~ R-58282 R-7951 Permit No. ~~44504~~.....
IN NAME OF

JOHN AEBI

Surveyed Oct. 1981, by L. TOLL.....