

T.7S.,R.5&6W.,W.M.

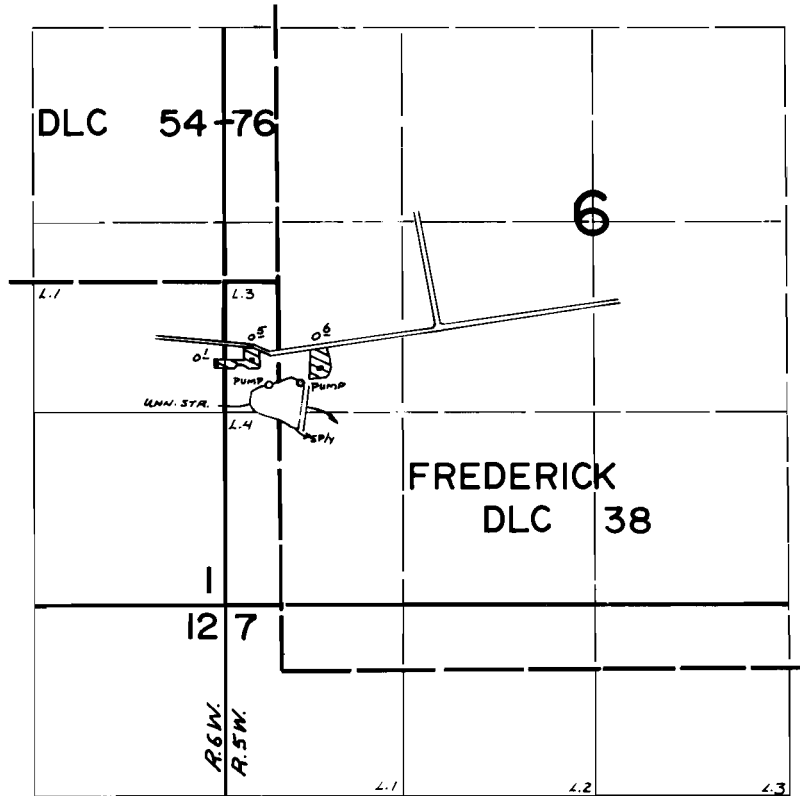

Dam Div. Loc.: 760' S., & 150' E. from SE Cor. Nicklin DLC 76.

FINAL PROOF SURVEY UNDER

R-58282 R-7951
 Application No. ~~58283~~ Permit No. ~~44504~~
 IN NAME OF

JOHN AEBI

Surveyed Oct. 1, 1981, by L. TOLL