

T. 3 N. R. 34 E. W.M.

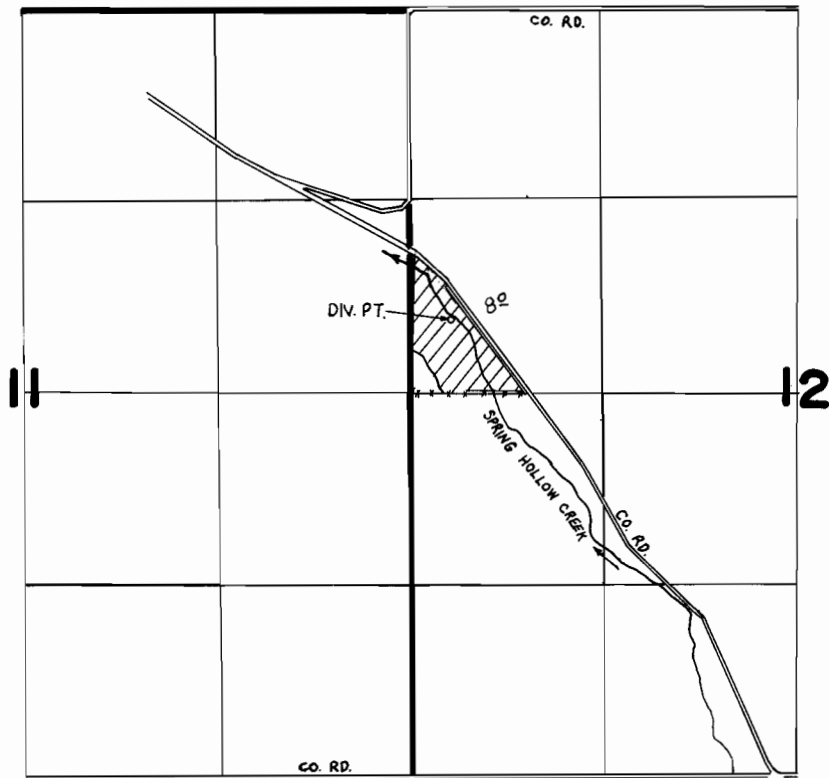

Scale 1" = 1320'



DIV. PT. Loc. 510' N. & 270' E. FROM W. 1/4 COR. SEC. 12

FINAL PROOF SURVEY UNDER

Application No. 58779 Permit No. 44744
IN NAME OF

RAWLEY STANLEY

Surveyed July 2, 1986, by V. Church