

G-9759

36285

T. 2 N., R. 32 E., W.M.

NE 1/4, SE 1/4, SEC. 35

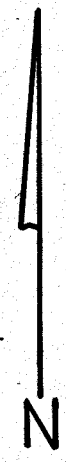
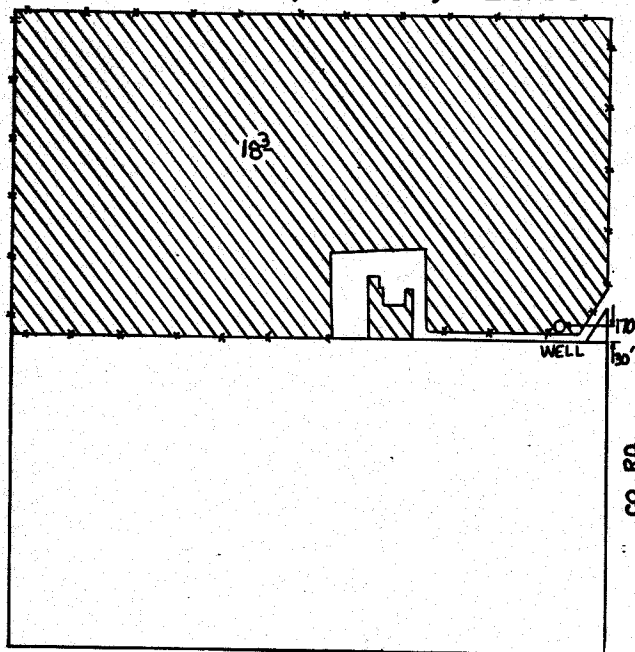

Scale 1" = 400'

FINAL PROOF SURVEY UNDER

Application No. G.10655. Permit No. G.9759.....
IN NAME OF

.....**GERALD L. ODMAN**.....

Surveyed Nov. 13, 1986, by V. Church.....