

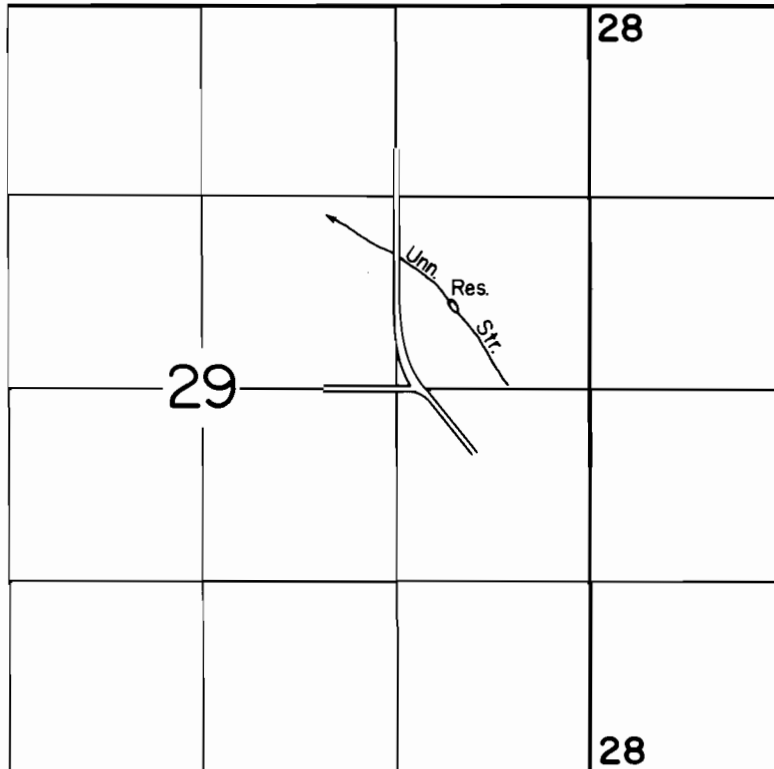

T. 1 S., R. 4 E., W.M.



DIV. PT. LOC: 600' N. & 960' W. FROM THE E. 1/4 CORNER SECTION 29

SCALE: 1" = 1320'

FINAL PROOF SURVEY
UNDER

R-58186 R-7797

Application No. 58187... Permit No. 43927.....

IN NAME OF

HAROLD F. & DOLORES P. VROOMAN

Surveyed OCT. 7... 1986, by T. WARREN.....

