

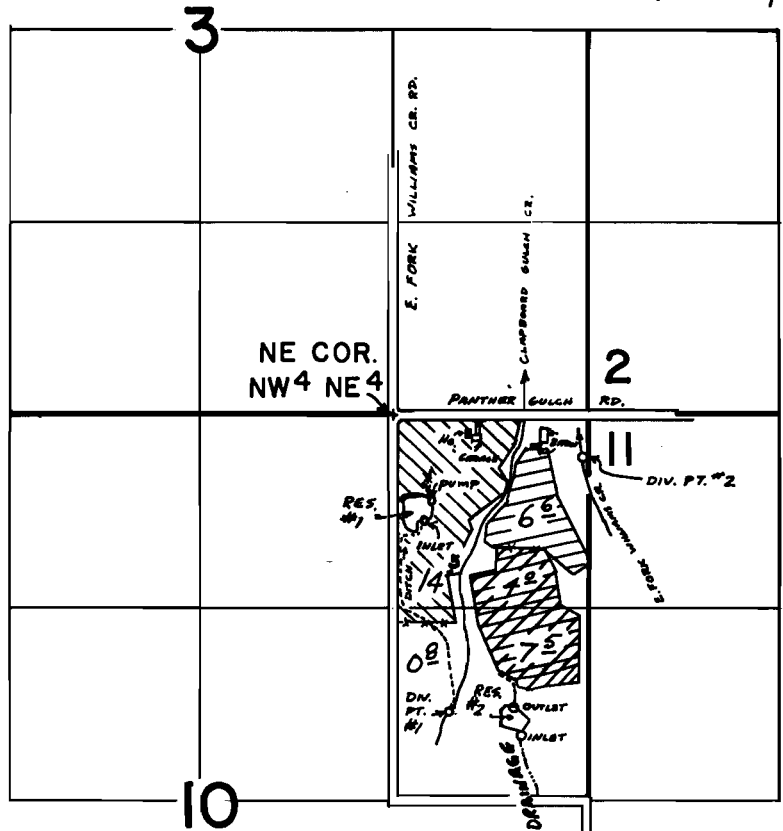



T.39 S., R.5 W., W.M.

RESERVOIRS LOCATED: *1- 570' S. & 240' E.,
 *2- 2000' S. & 830' E., BOTH
 FROM NE COR., NW 1/4 NE 1/4, SEC. 10.





DIV. PTS. LOCATED: *1 - 2030' S. & 350' E.

*2 - 290' S & 1290' E., BOTH
 FROM NE COR., NW 1/4 NE 1/4, SEC. 10.

-  Res *1 Permit 39935
-  Res *2 " "
-  Permit 40135

FINAL PROOF SURVEY UNDER

-  PRIMARY R-51671 R-6392
 51672 39935
-  SUPPLEMENTAL Application No. 536.7.7.. Permit No. 41035.....
 IN NAME OF

.....GEORGE.....BRETZ.....

Surveyed Oct. 3, 1980, by BRUCE R. SUND

Scale: 4" = 1 mile

PTS-1980-14B
 PTS-1979-14A