

T. 37 S., R. 6 W., W.M.

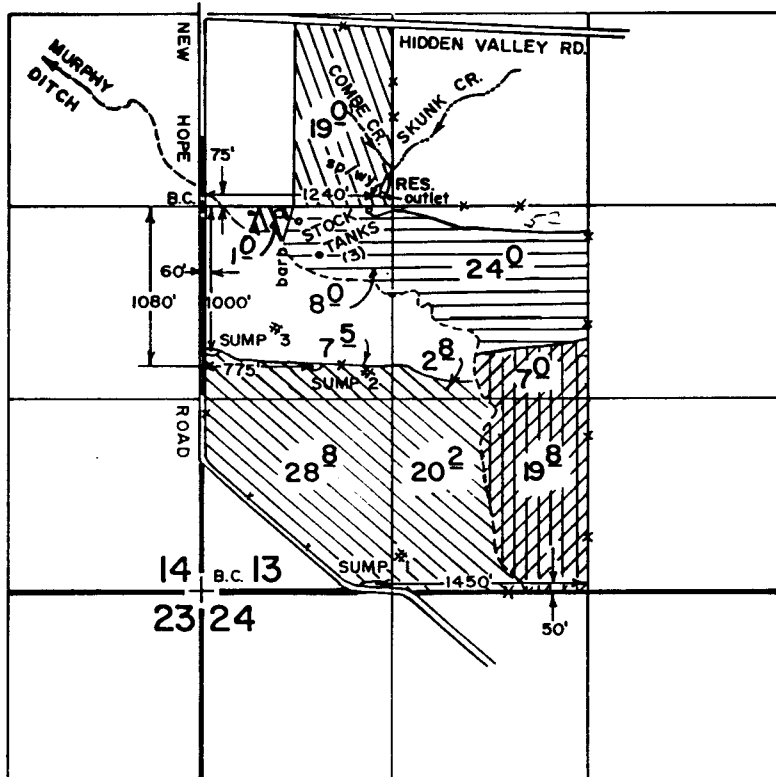

RECEIVED
 AUG 3 1987
 W.M. DIST. 14
 GRANTZ PARCELS, ORC.

FINAL PROOF SURVEY

UNDER

67523 48255
 R-56577 R-7348
 56578 43108





Application No. G-8936 Permit No. G-8334

IN NAME OF

CLYDE C. & D. BUD COMBE

Surveyed OCT. 4 19 83, by B. S. JAMES

SCALE: 4" = 1 MILE

-  SUP. from SUMP #1
-  SUP. from SUMPS #2 & #3
-  SUP. from RES.
-  PRIM. from SUMP #1
-  PRIM. from RES.